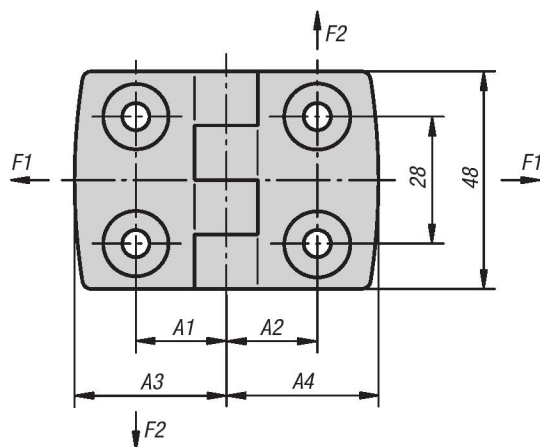
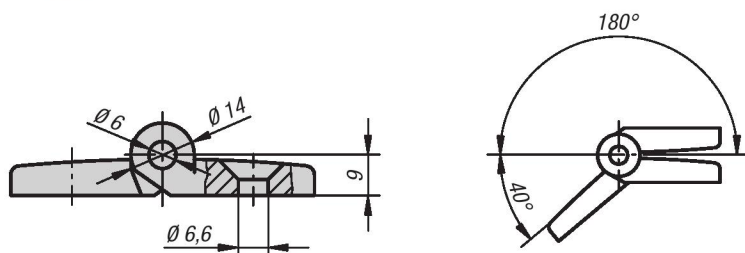

Hinges

aluminum

METRIC
Parts

New Item

**Material:**Die-cast aluminum.
Hinge pin stainless steel.**Type:**Hinge matt nickel-plated.
Pin natural finish.**Part Number Example:**

K0580.251515

Note:Hinges for panel elements and aluminum profiles.
Non-liftoff.**On request:**Hinges with guide tabs for aluminum profiles
(slots 5, 6, 8, 10, 12 and 14).
Unequal leaf combinations.

KIPP Hinges aluminum, metric

Item No.	A1	A2	A3	A4	F1 max. kN	F2 max. kN
K0580.251515	15	15	26	26	0,275	0,215
K0580.301818	17,5	17,5	29,5	29,5	0,325	0,225
K0580.352020	20	20	36	36	0,325	0,225
K0580.402323	22,5	22,5	38,5	38,5	0,4	0,25
K0580.452525	25	25	43,5	43,5	0,4	0,25
K0580.502828	27,5	27,5	48,5	48,5	0,4	0,25
K0580.603333	32,5	32,5	57,5	57,5	0,4	0,1