



Spring Plungers

ball style, hexagon socket, stainless steel



INCH
Parts

METRIC
Parts

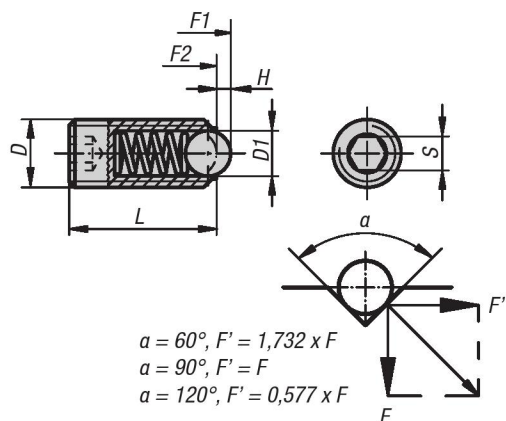

Material:

Body in stainless steel 1.4305;
ball in stainless steel 1.4034;
spring in stainless steel 1.4310

Type:

Natural finish. Ball hardened.

Part Number Example:

K0316.210

Application Diagram

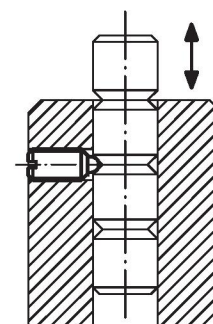

KIPP Spring Plungers, ball style, hexagon socket, stainless steel, standard end pressure, inch

Item No.	D	D1	L	H	S	Spring force initial pressure F1 approx. N	Spring force final pressure F2 approx. N
K0316.AJ	1/4-28	3.5	15	1	1/8	9	13
K0316.A2	1/4-20	3.5	15	1	1/8	9	13
K0316.A3	5/16-18	5	18	1.5	5/32	15	30
K0316.A4	3/8-16	6	23	2	3/16	20	35
K0316.A5	1/2-13	8	26	2.5	7/32	30	55
K0316.A6	5/8-11	10	33	3.5	5/16	65	125



Spring Plungers

ball style, hexagon socket, stainless steel

KIPP Spring Plungers, ball style, hexagon socket, stainless steel, heavy end pressure, inch

Item No.	D	D1	L	H	S	Spring force initial pressure F1 approx. N	Spring force final pressure F2 approx. N
K0316.2AJ	1/4-28	3.5	15	1	1/8	28	40
K0316.2A2	1/4-20	3.5	15	1	1/8	28	40
K0316.2A3	5/16-18	5	18	1.5	5/32	47	73
K0316.2A4	3/8-16	6	23	2	3/16	66	100
K0316.2A5	1/2-13	8	26	2.5	7/32	66	120
K0316.2A6	5/8-11	10	33	3.5	5/16	90	180

KIPP Spring Plungers, ball style, hexagon socket, stainless steel, standard end pressure, metric

Item No.	D	D1	L	H	S	Spring force initial pressure F1 approx. N	Spring force final pressure F2 approx. N
K0316.03	M3	1,5	9	0,4	1,5	1,5	3
K0316.04	M4	2,5	10	0,8	2	4	10
K0316.05	M5	3	14	0,9	2,5	6	11
K0316.06	M6	3,5	15	1	3	9	13
K0316.08	M8	5	18	1,5	4	15	30
K0316.10	M10	6	23	2	5	20	35
K0316.12	M12	8	26	2,5	6	30	55
K0316.16	M16	10	33	3,5	8	65	125
K0316.20	M20	12	43	4,5	10	80	160
K0316.24	M24	15	48	5,5	12	90	180

KIPP Spring Plungers, ball style, hexagon socket, stainless steel, heavy end pressure, metric

Item No.	D	D1	L	H	S	Spring force initial pressure F1 approx. N	Spring force final pressure F2 approx. N
K0316.203	M3	1,5	9	0,4	1,5	5	7
K0316.204	M4	2,5	10	0,8	2	12	22
K0316.205	M5	3	14	0,9	2,5	19	30
K0316.206	M6	3,5	15	1	3	28	40
K0316.208	M8	5	18	1,5	4	47	73
K0316.210	M10	6	23	2	5	66	100
K0316.212	M12	8	26	2,5	6	66	120
K0316.216	M16	10	33	3,5	8	90	180
K0316.220	M20	12	43	4,5	10	115	240
K0316.224	M24	15	48	5,5	12	130	270