

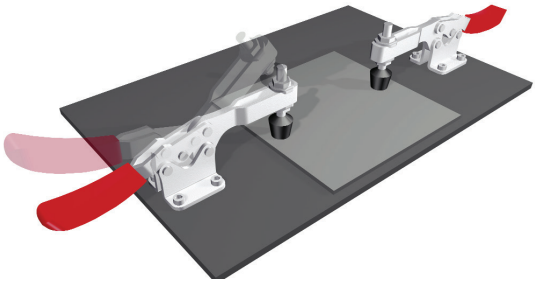
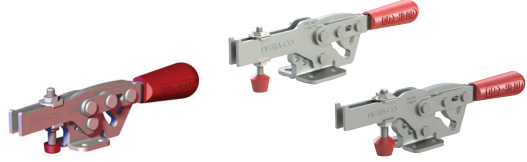
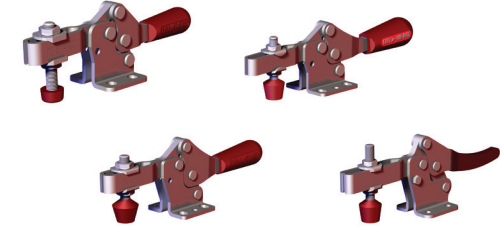
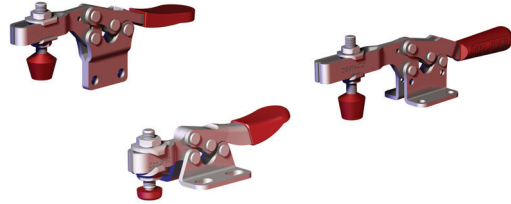
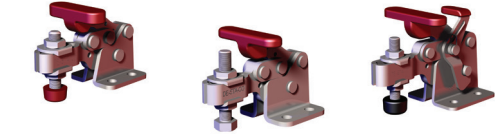

# HORIZONTAL HOLD DOWN CLAMPS

## Sizing and Application Chart

	Series	Page: MC-HHC-#	Max. Holding Capacity N[lbf.]						Height Under Clamping Bar mm [inch]				Overall Height mm [inch]								
			0 to 1000 [0 to 225]	1000 to 2000 [225 to 450]	2000 to 3000 [450 to 675]	3000 to 5000 [675 to 1125]	5000 to 7000 [1125 to 1575]	7000 to 10000 [1575 to 2250]	0 to 10 [0 to 0.39]	10 to 20 [0.39 to 0.79]	20 to 30 [0.79 to 1.18]	30 to 40 [1.18 to 1.57]	40 to 50 [1.57 to 1.97]	50 to 60 [1.97 to 2.36]	0 to 25 [0 to 0.98]	25 to 40 [0.98 to 1.57]	40 to 55 [1.57 to 2.17]	55 to 70 [1.57 to 2.76]	70 to 85 [2.76 to 3.35]	85 to 100 [3.35 to 3.94]	100+ [1.57+]
	2013	3																			
	2017	5																			
	2027	7																			
	213	9																			
	217	11																			
	227	13																			
	237	15																			
	245	17																			
	205	19																			
	215	21																			
	225	23																			
	235	25																			
	305	27																			
	307	27																			
	309	27																			
	206	29																			
	5305	31																			
	5310	31																			

# HORIZONTAL HOLD DOWN CLAMPS

## Sizing and Application Chart

Overall Length mm [inch]		Overall Width mm [inch]		Suitable Application Area										Standard Material	Arm Style	Mounting Style			Service Environment													
50 to 75 [1.97 to 2.95]	75 to 100 [2.95 to 3.94]	100 to 125 [3.94 to 4.92]	125 to 150 [4.92 to 5.91]	150 to 175 [5.91 to 6.89]	175 to 200 [6.89 to 7.87]	200 to 225 [7.87 to 8.86]	225 to 250 [8.86 to 9.84]	250+ [9.84+]	0 to 25 [0 to 0.98]	25 to 40 [0.98 to 1.57]	40 to 55 [1.57 to 2.17]	55 to 70 [1.57 to 2.76]	Welding	Assembly	Checking Fixtures	Machining	Woodworking	Closures	Food Processing	Duty Cycle	Steel	Stainless Steel	Toggle Lock Plus	U-Bar Version	Solid Arm Version	Straight Base	Flanged Base	Weid-On Mounting	Normal	Harsh/Dirty		
			■							■			○	●	●	●	●	●	⊗	○	✓		✓	✓			✓		✓			
						■				■			○	●	●	●	●	●	⊗	○	✓		✓	✓			✓		✓			
							■			■			○	●	●	○	●	●	⊗	○	✓		✓	✓			✓		✓			
								■		■			○	●	●	●	●	●	○	○	✓	✓		✓	✓		✓	✓		✓		
■								■		■			○	●	●	●	●	●	○	○	✓	✓		✓	✓		✓	✓		✓		
			■							■			○	●	●	●	●	●	○	○	✓	✓		✓	✓		✓	✓		✓		
				■						■			○	●	●	●	●	●	○	○	✓	✓		✓	✓		✓	✓		✓		
								■		■			○	●	●	●	●	●	○	○	✓	✓	✓	✓			✓		✓		✓	
■										■			○	●	○	●	●	●	○	○	✓	✓	✓	✓			✓		✓		✓	
	■									■			○	●	○	○	●	●	○	○	✓	✓	✓	✓			✓		✓		✓	
			■							■			○	●	○	○	●	●	○	○	✓	✓	✓	✓			✓		✓		✓	
■										■			○	●	○	●	○	●	○	○	✓	✓		✓			✓		✓		✓	
								■		■			○	●	○	○	●	●	⊗	○	✓	✓	✓			✓		✓		✓	✓	✓
								■		■			○	●	○	○	●	●	⊗	○	✓	✓	✓			✓		✓		✓	✓	✓

● Excellent/High ○ Fair/Medium ● Poor/Low ⊗ Not Recommended

# 2013 SERIES

## Horizontal Hold Down Clamps | Product Overview

### Features:

- Increased handle clearance reduces pinch points
- Common mounting hole pattern to Model 213
- Fixed handle pivot provides smooth action
- Nearly 2 times the holding capacity Model 213
- BLK models feature a black, non-reflective finish

### Applications:

- Checking fixtures
- Assembly & test
- Light machining
- Woodworking
- Closures

### Also Available:

See page MC-ACC-1 for accessories

Accommodates M5 or #10 spindle accessory

Covered under one or more U.S./International Patents

**2013-U**  
Flanged Base  
U-Bar

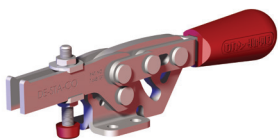

**2013-U-LS-BLK** ⓘ  
Blackout Series  
Flanged Base, U-Bar



**2013-UR**  
Flanged Base, U-Bar  
with DE-STA-CO®  
Toggle Lock  
Plus

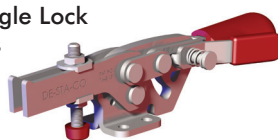

Note: Clamps shown with included accessories.

ⓘ This item is available upon request

## Technical Information

Model	Max. Holding Capacity	Clamp Bar Opening (+10°)	Handle Opening (+10°)	Weight	Accessories (Supplied)	
					Spindle Assembly	Flanged Washers
2013-U	1310 N [295 lbf]	71°	58°	0,17kg [0.37lb]	2013208-M	102111
2013-U-LS-BLK ⓘ					--	102111-BLK
2013-UR					2013208-M	102111

ⓘ This item is available upon request

## Holding Capacities

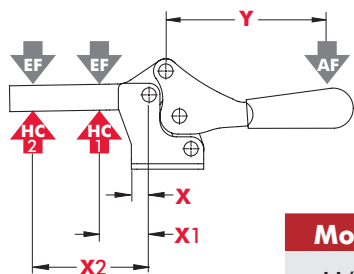

Model	X	X1	X2	Y	±HC1	±HC2	±EF(X1):AF	±EF(X2):AF
U/UR	[0.63] 16	[0.95] 24	[1.95] 49,5	[2.34] 59,5	[295lbf.] 1310N	[175lbf.] 780N	6:1	4:1

Dimensions shown "mm [inch]" ± HC = Holding Capacity, EF = Exerting Force, AF = Applied Force  
Refer to See page MC-TEC-4 for additional information.

# 2013 SERIES

## Horizontal Hold Down Clamps | Dimensions | -U/-UR

**2013-U**  
Flanged Base  
U-Bar

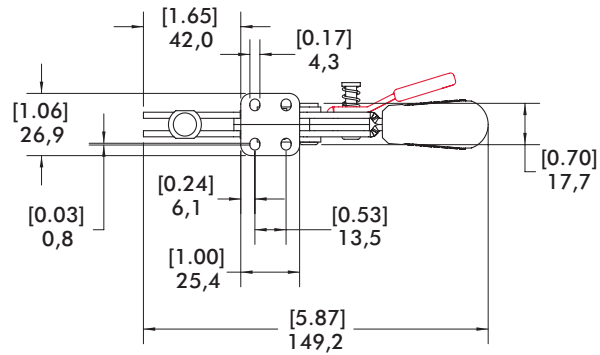
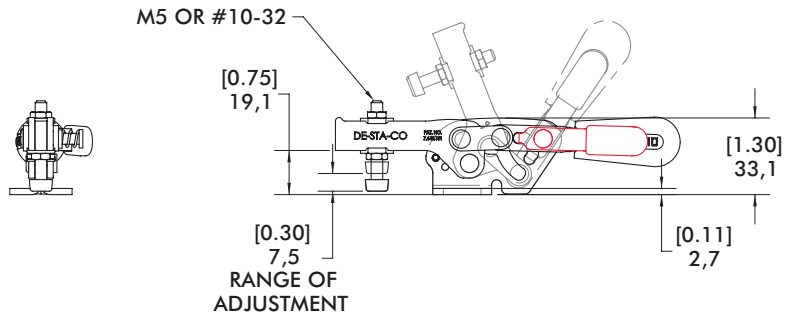
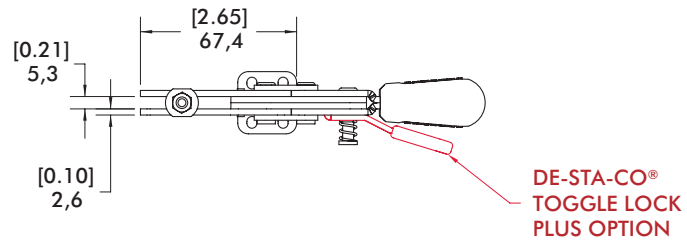
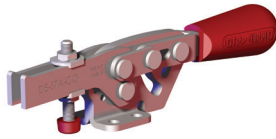

mm [INCH]  
THIRD ANGLE PROJECTION

# 2017 SERIES

## Horizontal Hold Down Clamps | Product Overview

### Features:

- Increased handle clearance reduces pinch points
- Common mounting hole pattern to Model 217
- Fixed handle pivot provides smooth action
- Over 2½ times the holding capacity Model 217
- BLK models feature a black, non-reflective finish

### Applications:

- Checking fixtures
- Assembly & test
- Light machining
- Woodworking
- Closures

### Also Available:

See page MC-ACC-1 for accessories

Accommodates M6 or ¼" spindle accessory

Covered under one or more U.S./International Patents

### 2017-U Flanged Base U-Bar



### 2017-U-LS-BLK ⓘ Blackout Series Flanged Base U-Bar



### 2017-UR Flanged Base, U-Bar with DE-STA-CO® Toggle Lock Plus



Note: Clamps shown with included accessories.

ⓘ This item is available upon request

## Technical Information

Model	Max. Holding Capacity	Clamp Bar Opening (+10°)	Handle Opening (+10°)	Weight	Accessories (Supplied)	
					Spindle Assembly	Flanged Washers
2017-U	2500 N [560 lbf]	73°	69°	0,44kg [0.97lb]	215208-M	215105
2017-U-LS-BLK ⓘ					--	215105-BLK
2017-UR					215208-M	215105

ⓘ This item is available upon request

## Holding Capacities

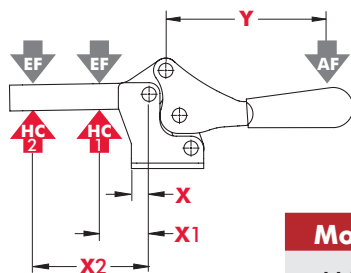

Model	X	X1	X2	Y	‡HC1	‡HC2	‡EF(X1):AF	‡EF(X2):AF
U/UR	[1.08] 27,4	[1.65] 42	[3.15] 80	[2.54] 64,5	[560lbf.] 2500N	[245lbf.] 1090N	5:1	2.5:1

Dimensions shown "mm [inch]" ‡ HC = Holding Capacity, EF = Exerting Force, AF = Applied Force  
Refer to See page MC-TEC-4 for additional information.

## Horizontal Hold Down Clamps | Dimensions | -U/-UR

**2017-U**  
Flanged Base  
U-Bar

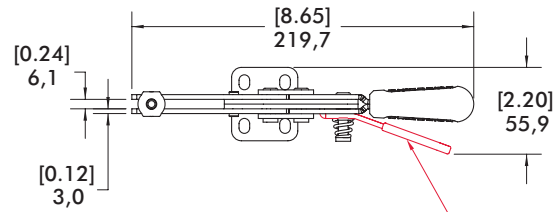

DE-STA-CO®  
TOGGLE LOCK  
PLUS OPTION

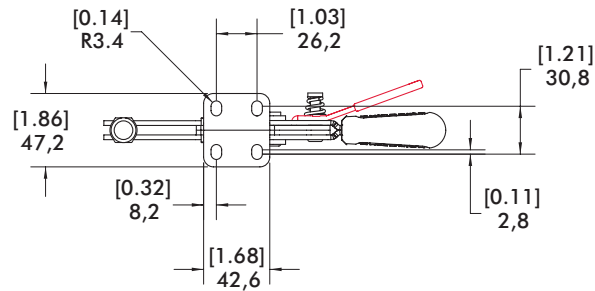
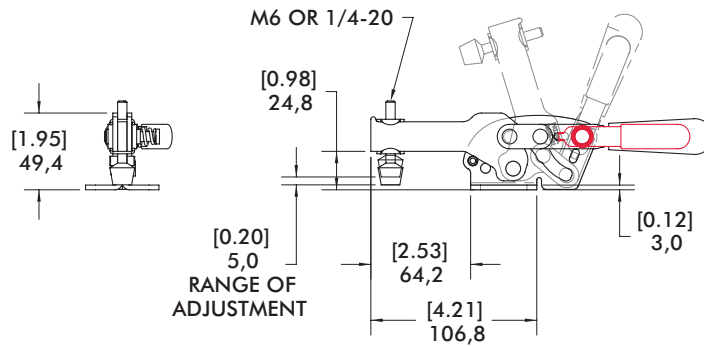

mm [INCH]  
THIRD ANGLE  
PROJECTION

# 2027 SERIES

## Horizontal Hold Down Clamps | Product Overview

### Features:

- Increased handle clearance reduces pinch points
- Common mounting hole pattern to Model 227
- Fixed handle pivot provides smooth action
- Over 1½ times the holding capacity Model 227
- BLK models feature a black, non-reflective finish

### Applications:

- Checking fixtures
- Assembly & test
- Light machining
- Woodworking
- Closures

### Also Available:

See page MC-ACC-1 for accessories  
Accommodates M8 or 5/16" spindle accessory

Covered under one or more U.S./International Patents

**2027-U**  
Flanged Base  
U-Bar



**2027-U-LS-BLK** ⓘ  
Blackout Series  
Flanged Base  
U-Bar



**2027-UR**  
Flanged Base, U-Bar  
with DE-STA-CO®  
Toggle Lock  
Plus



Note: Clamps shown with included accessories.

ⓘ This item is available upon request

## Technical Information

Model	Max. Holding Capacity	Clamp Bar Opening (+10°)	Handle Opening (+10°)	Weight	Accessories (Supplied)	
					Spindle Assembly	Flanged Washers
2027-U	3740 N [840 lbf]	68°	70°	0,61kg [1.34lb]	2007208-M	507107
2027-U-LS-BLK ⓘ					--	507107-BLK
2027-UR					2007208-M	507107

ⓘ This item is available upon request

## Holding Capacities

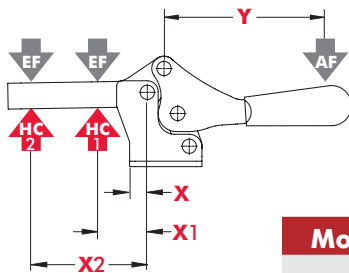

Model	X	X1	X2	Y	‡HC1	‡HC2	‡EF(X1):AF	‡EF(X2):AF
U/UR	[1.02] 25,8	[1.75] 44,5	[3.30] 83,8	[2.54] 64,5	[840lbf.] 3740N	[480lbf.] 2140N	5:1	3:1

Dimensions shown "mm [inch]" ‡ HC = Holding Capacity, EF = Exerting Force, AF = Applied Force  
Refer to See page MC-TEC-4 for additional information.

# 2027 SERIES

## Horizontal Hold Down Clamps | Dimensions | -U/-UR

**2027-U**  
Flanged Base  
U-Bar

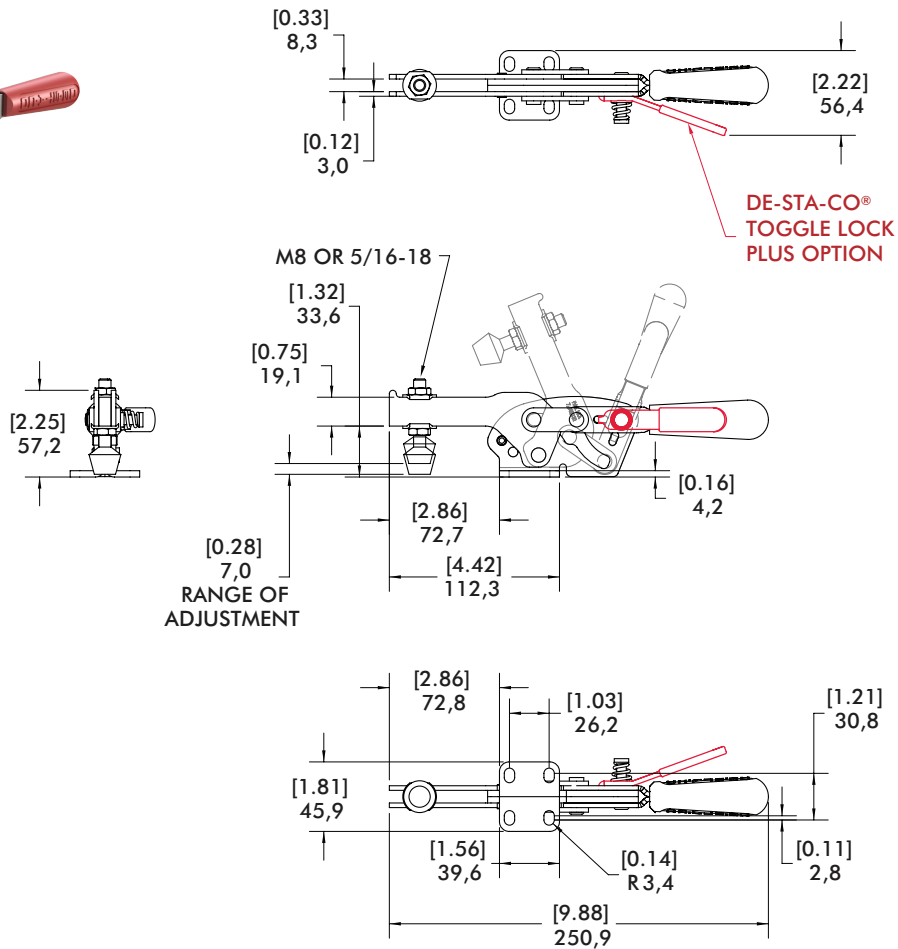



# 213 SERIES

## Horizontal Hold Down Clamps | Product Overview

### Features:

- Low profile
- Large handle clearance in the open position
- Available in stainless steel
- BLK models feature a black, non-reflective finish

### Applications:

- Assembly
- Checking fixtures
- Closures
- Woodworking

### Also Available:

See page MC-ACC-1 for accessories  
Accommodates M5 or #10 spindle accessory

**213-U**  
Flanged Base  
U-Bar

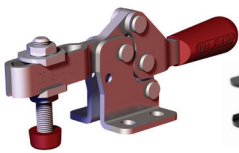

**213-U-LS-BLK** ⓘ  
Blackout Series  
Flanged Base  
U-Bar



**213-USS**  
Flanged Base  
U-Bar, Stainless  
Steel

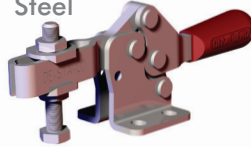

**213-UB**  
Straight Base  
U-Bar

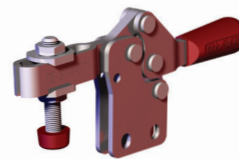

**213-UB-LS-BLK** ⓘ  
Blackout Series  
Straight Base  
U-Bar



**213-U-L** ⓘ  
Flanged Base  
Open Bar

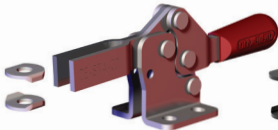

**213-U-L-BLK** ⓘ  
Flanged Base  
Open Bar



**213-UB-L** ⓘ  
Straight Base  
Open Bar

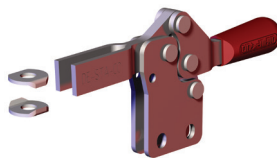

**213-UB-L-BLK** ⓘ  
Blackout Series  
Straight Base  
Open Bar



Note: Clamps shown with included accessories.

ⓘ This item is available upon request

## Technical Information

Model	Max. Holding Capacity	Clamp Bar Opening (+10°)	Handle Opening (+10°)	Weight	Accessories (Supplied)	
					Spindle Assembly	Flanged Washers
213-U	670 N [150 lbf]	90°	60°	0,08kg [0.17lb]	213208-M	102111
213-U-LS-BLK ⓘ					--	102111-BLK
213-USS					201943-M	102911
213-UB					213208-M	102111
213-UB-LS-BLK ⓘ					--	102111-BLK
213-U-L ⓘ						102111
213-U-L-BLK ⓘ						102111-BLK
213-UB-L ⓘ						102111
213-UB-L-BLK ⓘ						102111-BLK

ⓘ This item is available upon request

# 213 SERIES

## Horizontal Hold Down Clamps | Holding Capacities

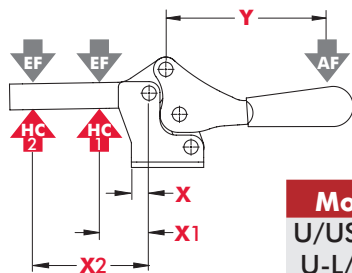

Model	X	X1	X2	Y	±HC1	±HC2	±EF(X1):AF	±EF(X2):AF
U/USS/UB	[0.36]	[0.75]	[1.63]	[1.81]	[150lbf.]	[70lbf.]	7:1	3:1
U-L/UB-L	9,3	19	41,4	46	670N	310N		

Dimensions shown "mm [inch]" ± HC = Holding Capacity, EF = Exerting Force, AF = Applied Force  
Refer to See page MC-TEC-4 for additional information.

### Standard Clamp Dimensions | -U/-USS/-UB

**213-U**  
Flanged Base  
U-Bar

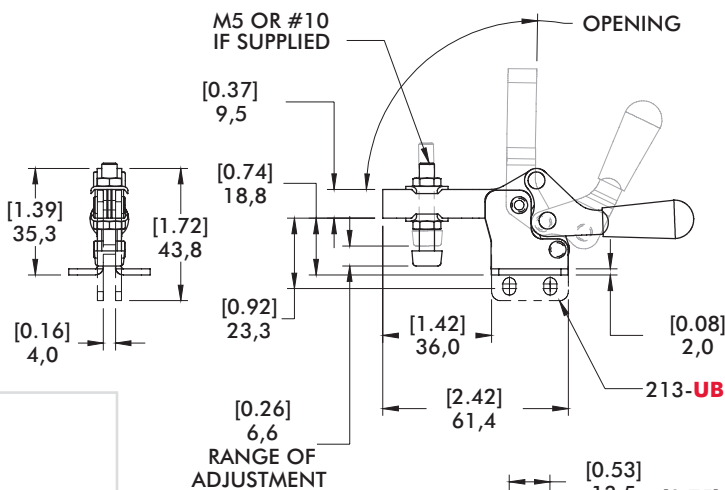
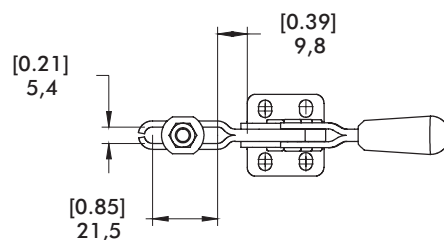
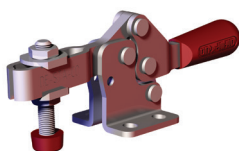

### Series 213 Open Bar Options

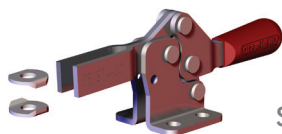

**Flanged Base**  
Model  
**213-U-L**

See page MC-ACC-7 for Complete offering of Open bar accessories

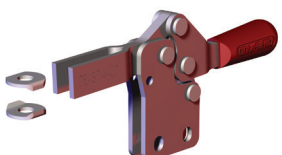
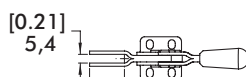

**Straight Base**  
Model  
**213-UB-L**

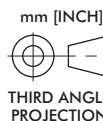
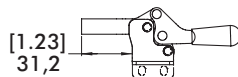

# 217 SERIES

## Horizontal Hold Down Clamps | Product Overview

### Features:

- Low profile
- Large handle clearance in the open position
- Available in stainless steel
- BLK models feature a black, non-reflective finish

### Applications:

- Assembly
- Checking fixtures
- Closures
- Woodworking

### Also Available:

See page MC-ACC-1 for accessories  
Accommodates M6 or 1/4" spindle accessory

**217-U**  
Flanged Base  
U-Bar

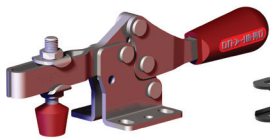

**217-U-LS-BLK** ⓘ  
Blackout Series  
Flanged Base  
U-Bar



**217-USS**  
Flanged Base  
U-Bar, Stainless  
Steel

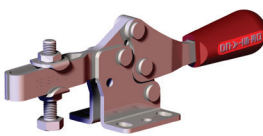

**217-UB**  
Straight Base  
U-Bar

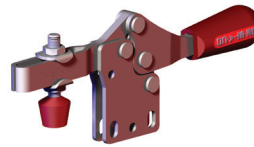

**217-UB-LS-BLK** ⓘ  
Blackout Series  
Straight Base  
U-Bar



**217-U-L** ⓘ  
Flanged Base  
Open Bar

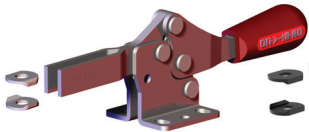

**217-U-L-BLK** ⓘ  
Flanged Base  
Open Bar



**217-UB-L** ⓘ  
Straight Base  
Open Bar

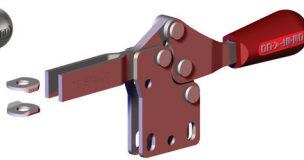

**217-UB-L-BLK** ⓘ  
Blackout Series  
Straight Base  
Open Bar



Note: Clamps shown with included accessories.

ⓘ This item is available upon request

## Technical Information

Model	Max. Holding Capacity	Clamp Bar Opening (+10°)	Handle Opening (+10°)	Weight	Accessories (Supplied)	
					Spindle Assembly	Flanged Washers
217-U	900 N [200 lbf]	91°	61°	0,18kg [0.40lb]	202208-M	215105
217-U-LS-BLK ⓘ					--	215105-BLK
217-USS	1110 N [250 lbf]				202943-M	215105
217-UB					202208-M	215105
217-UB-LS-BLK ⓘ						215105-BLK
217-U-L ⓘ	900 N [200 lbf]					215105
217-U-L-BLK ⓘ						215105-BLK
217-UB-L ⓘ						215105
217-UB-L-BLK ⓘ			215105-BLK			

ⓘ This item is available upon request

# 217 SERIES

## Horizontal Hold Down Clamps | Holding Capacities

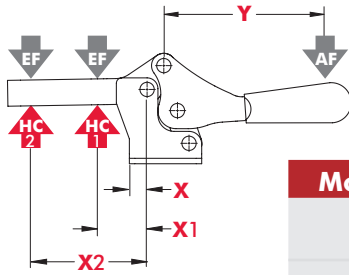

Model	X	X1	X2	Y	±HC1	±HC2	±EF(X1):AF	±EF(X2):AF
U					[200lb.f.] 900N	[80lb.f.] 360N		
USS	[0.53] 13,5	[1.13] 28,6	[2.63] 66,8	[2.93] 74,5	[250lb.f.] 1110N	[100lb.f.] 440N	7:1	3:1
UB/U-L/ UB-L					[200lb.f.] 900N	[80lb.f.] 360N		

Dimensions shown "mm [inch]" ± HC = Holding Capacity, EF = Exerting Force, AF = Applied Force  
Refer to See page MC-TEC-4 for additional information.

## Standard Clamp Dimensions | -U/-USS/-UB

### Series 217 Open Bar Options

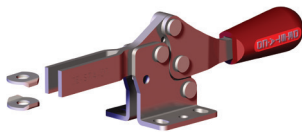

**Flanged Base**  
Model  
**217-U-L** ⓘ

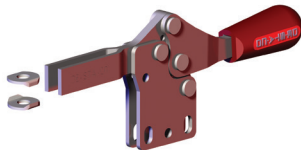

**Straight Base**  
Model  
**217-UB-L** ⓘ

See page MC-ACC-7 for  
Complete offering of  
Open bar accessories

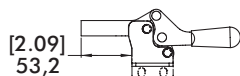
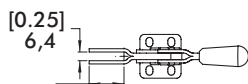

**217-U**  
Flanged Base  
U-Bar

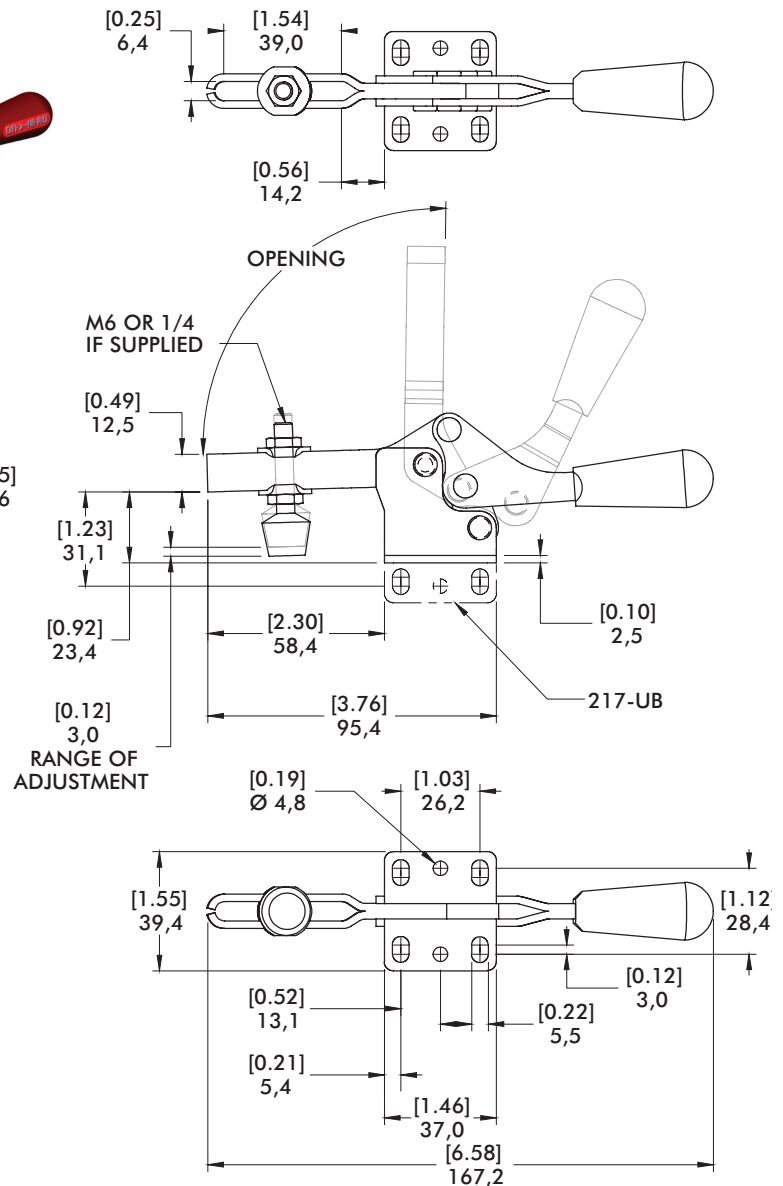
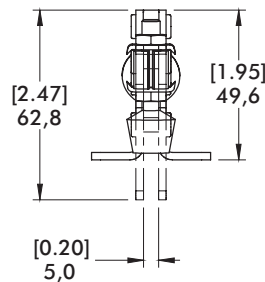
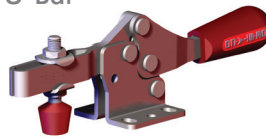

# 227 SERIES

## Horizontal Hold Down Clamps | Product Overview

### Features:

- Low profile
- Large handle clearance in the open position.
- Available in stainless steel
- BLK models feature a black, non-reflective finish

### Applications:

- Assembly
- Checking fixtures
- Closures
- Woodworking

### Also Available:

See page MC-ACC-1 for accessories  
Accommodates M6 or 5/16" spindle accessory

**227-U**  
Flanged Base  
U-Bar

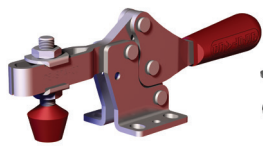

**227-U-LS-BLK** ⓘ  
Blackout Series  
Flanged Base  
U-Bar



**227-USS**  
Flanged Base  
U-Bar, Stainless  
Steel

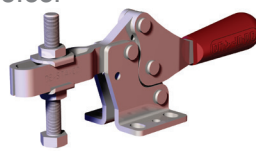

**227-UB**  
Straight Base  
U-Bar

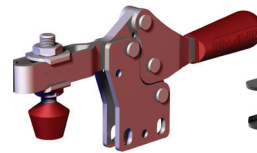

**227-UB-LS-BLK** ⓘ  
Blackout Series  
Straight Base  
U-Bar



**227-U-L** ⓘ  
Flanged Base  
Open Bar

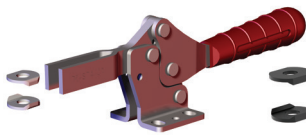

**227-U-L-BLK** ⓘ  
Blackout Series  
Flanged Base  
Open Bar



**227-UB-L** ⓘ  
Straight Base  
Open Bar

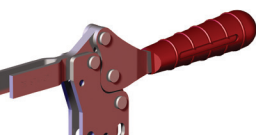

**227-UB-L-BLK** ⓘ  
Blackout Series  
Straight Base  
Open Bar



Note: Clamps shown with included accessories.

ⓘ This item is available upon request

## Technical Information

Model	Max. Holding Capacity	Clamp Bar Opening (+10°)	Handle Opening (+10°)	Weight	Accessories (Supplied)	
					Spindle Assembly	Flanged Washers
227-U	2220 N [500 lbf]	91°	56°	0,31kg [0.68lb]	225208-M	507107
227-U-LS-BLK ⓘ					--	507107-BLK
227-USS	2670 N [600 lbf]				-207943-M	507907
227-UB	2220 N [500 lbf]				225208-M	507107
227-UB-LS-BLK ⓘ					--	507107-BLK
227-U-L ⓘ					--	507107
227-U-L-BLK ⓘ					--	507107-BLK
227-UB-L ⓘ					--	507107
227-UB-L-BLK ⓘ		--	507107-BLK			

ⓘ This item is available upon request

# 227 SERIES

## Horizontal Hold Down Clamps | Holding Capacities

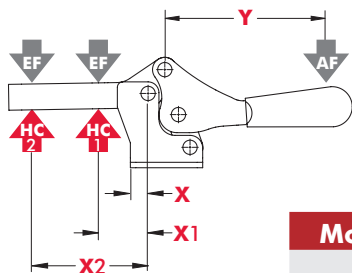

Model	X	X1	X2	Y	±HC1	±HC2	±EF(X1):AF	±EF(X2):AF
U					[500lbf.] 2220N	[225lbf.] 1000N		
USS	[0.39] 10,0	[1.25] 31,8	[2.75] 70,0	[3.58] 91,0	[600lbf.] 2670N	[270lbf.] 1200N	8:1	3:1
UB/U-L/ UB-L					500lbf.] 2220N	[225lbf.] 1000N		

Dimensions shown "mm [inch]" ± HC = Holding Capacity, EF = Exerting Force, AF = Applied Force  
Refer to See page MC-TEC-4 for additional information.

### Standard Clamp Dimensions | -U/-USS/-UB

**227-U**  
Flanged Base  
U-Bar

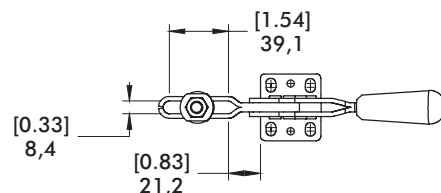
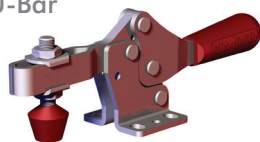

### Series 227 Open Bar Options

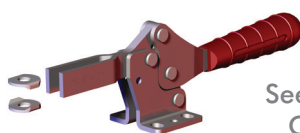

Flanged Base  
**Model**  
227-U-L ⓘ

See page MC-ACC-7 for Complete offering of Open bar accessories

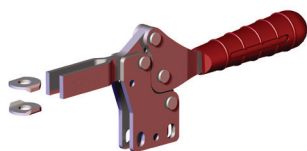
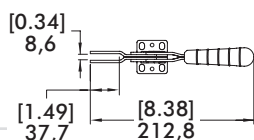

Straight Base  
**Model**  
227-UB-L ⓘ

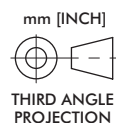
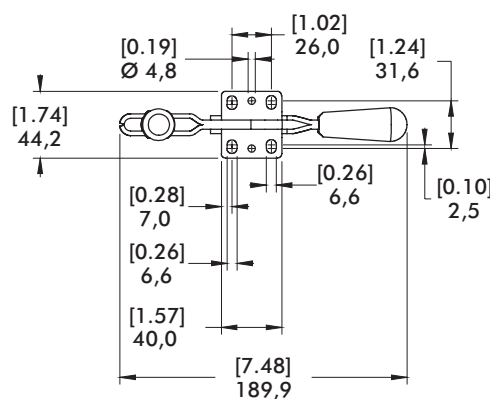
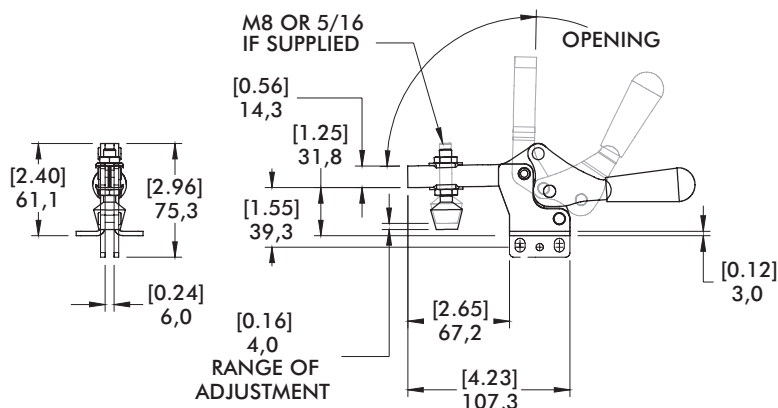
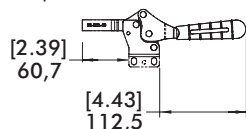

# 237 SERIES

## Horizontal Hold Down Clamps | Product Overview

### Features:

- Low profile
- Large handle clearance in the open position.
- Available in stainless steel

### Applications:

- Assembly
- Checking fixtures
- Welding

### Also Available:

See page MC-ACC-1 for accessories

Accommodates M10 or  $\frac{3}{8}$ " spindle accessory

**237-U**  
Flanged Base  
U-Bar

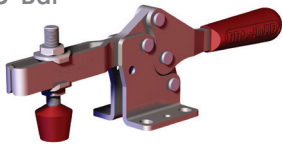

**237-USS** ⓘ  
Flanged Base  
U-Bar, Stainless  
Steel

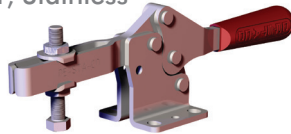

### Note:

Clamps shown with included accessories.

## Technical Information

Model	Max. Holding Capacity	Clamp Bar Opening(+10°)	Handle Opening (+10°)	Weight	Accessories (Supplied)	
					Spindle Assembly	Flanged Washers
237-U	3340 N [750 lbf]	93°	59°	0,73kg [1.60lb]	240208-M	235106
237-USS ⓘ	3780 N [850 lbf]				237943-M	235906

ⓘ This item is available upon request

## Holding Capacities

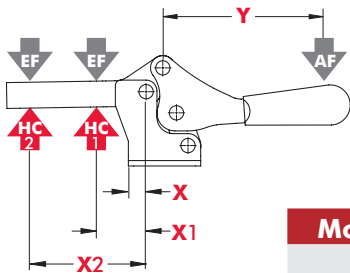

Model	X	X1	X2	Y	±HC1	±HC2	±EF(X1):AF	±EF(X2):AF
U	[0.81]	[1.75]	[4.50]	[5.25]	[750lbf.] 3340N	[290lbf.] 1290N	6:1	2:1
USS	20,6	44,5	114,3	133,3	[850lbf.] 3780N	[330lbf.] 1470N		

Dimensions shown "mm [inch]" ± HC = Holding Capacity, EF = Exerting Force, AF = Applied Force  
Refer to See page MC-TEC-4 for additional information.

# 237 SERIES

## Horizontal Hold Down Clamps | Dimensions | -U/-USS

**237-U**  
Flanged Base  
U-Bar

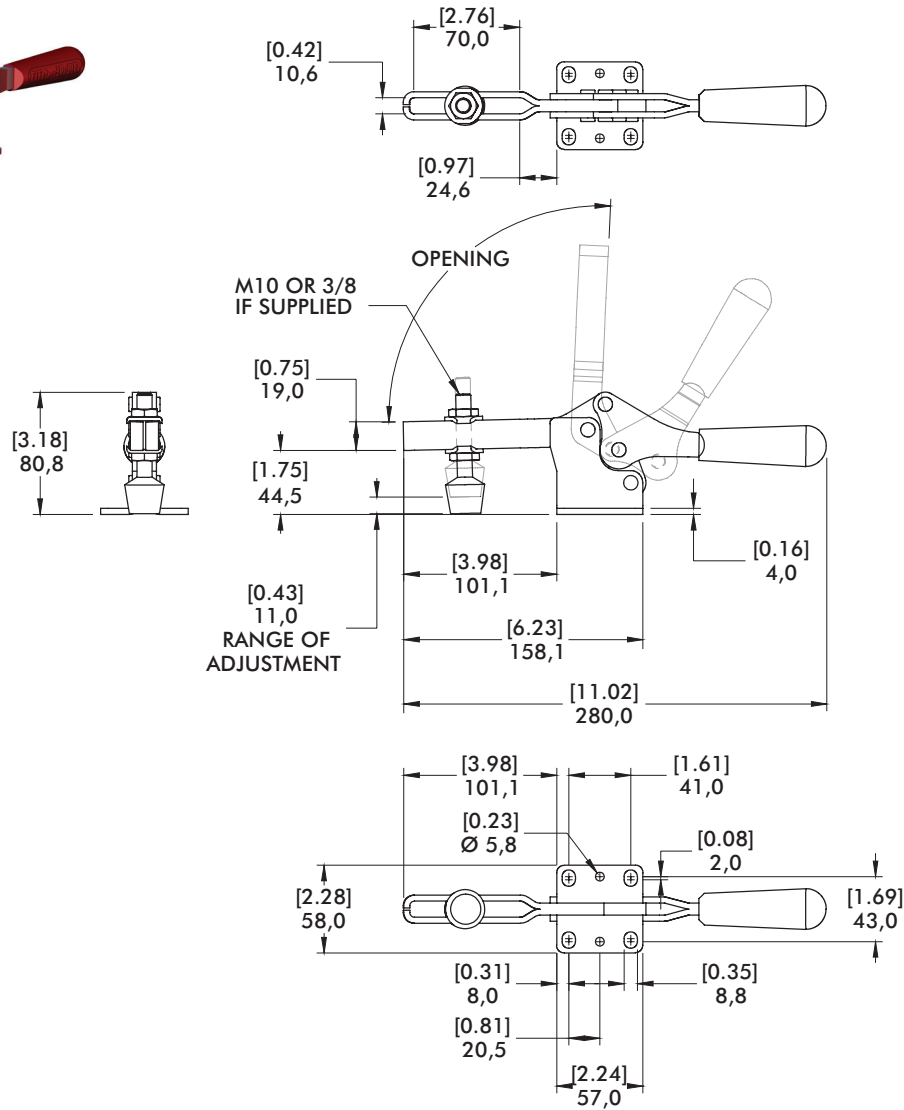
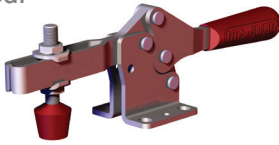



# 245 SERIES

## Horizontal Hold Down Clamps | Product Overview

### Features:

- Low profile
- Large handle clearance in the open position.

### Applications:

- Assembly
- Checking fixtures
- Welding

### Also Available:

See page MC-ACC-1 for accessories

Accommodates M12 or 1/2" spindle accessory

### 245-U Flanged Base U-Bar

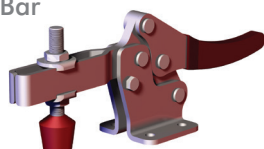

### Note:

Clamps shown with included accessories.

## Technical Information

Model	Max. Holding Capacity	Clamp Bar Opening (+10°)	Handle Opening (+10°)	Weight	Accessories (Supplied)	
					Spindle Assembly	Flanged Washers
245-U	4450 N [1000 lbf]	105°	74°	1,32kg [2.90lb]	247208-M	247109

## Holding Capacities

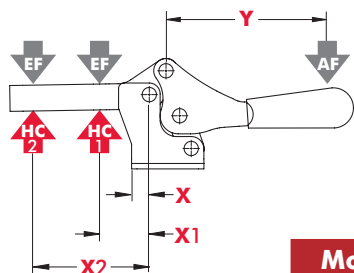

Model	X	X1	X2	Y	±HC1	±HC2	±EF(X1):AF	±EF(X2):AF
U	[0.50] 12,7	[2.00] 50,8	[5.00] 127	[6.09] 154,7	[1000lbf.] 4450N	[400lbf.] 1780N	11:1	5:1

Dimensions shown "mm [inch]" ‡ **HC** = Holding Capacity, **EF** = Exerting Force, **AF** = Applied Force  
Refer to See page MC-TEC-4 for additional information.

# 245 SERIES

## Horizontal Hold Down Clamps | Dimensions

**245-U**  
Flanged Base  
U-Bar

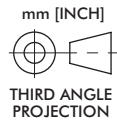
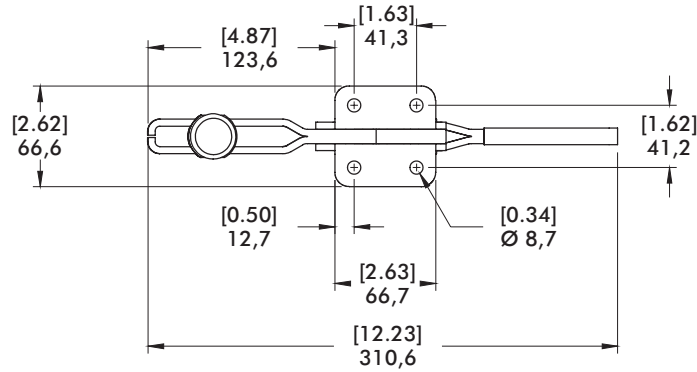
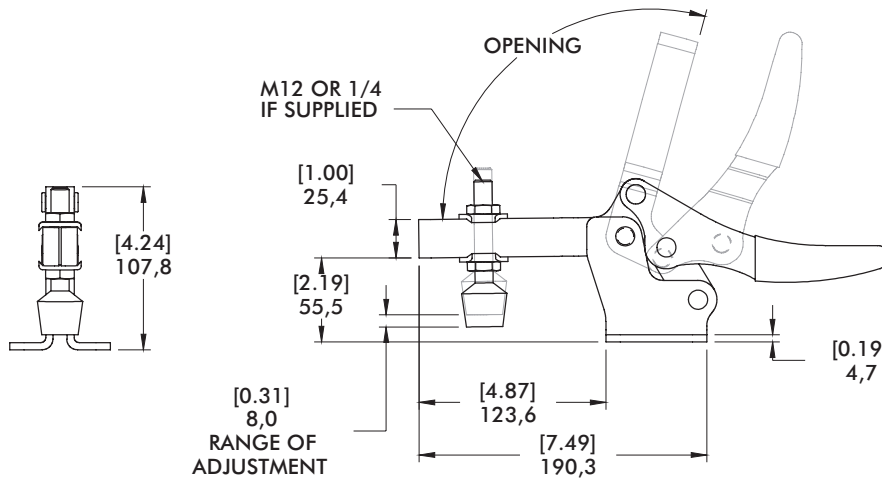
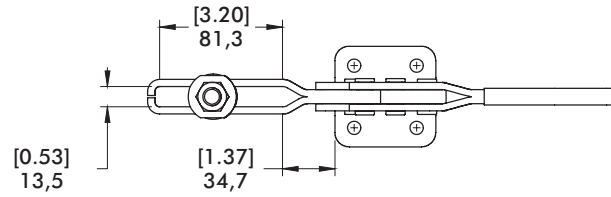
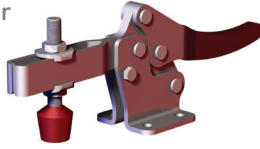

# 205 SERIES

## Horizontal Hold Down Clamps | Product Overview

### Features:

- Smallest of the Horizontal Hold Down clamps
- Ideal for light duty clamping in tight spaces
- Stainless steel models furnished without plastic grip

### Applications:

- Assembly
- Closures
- Woodworking
- Light duty clamping

### Also Available:

See page MC-ACC-1 for accessories  
Accommodates M4 or #8 spindle accessory

**205-U**  
Flanged Base  
U-Bar

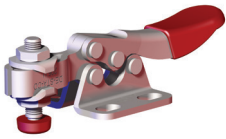

**205-UB** ⓘ  
Straight Base  
U-Bar



**205-UL** ⓘ  
Left Flanged  
Base, U-Bar

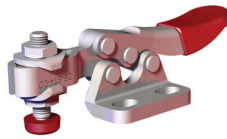

**205-UR** ⓘ  
Right Flanged  
Base, U-Bar

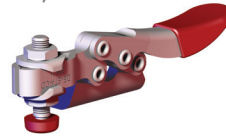

**205-USS**  
Flanged Base  
U-Bar, Stainless  
Steel

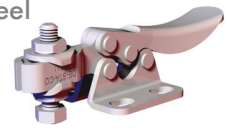

**205-S**  
Flanged Base  
Solid Bar



**205-SB** ⓘ  
Straight Base  
Solid Bar

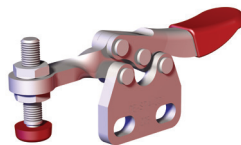

**205-SL** ⓘ  
Left Flanged Base,  
Solid Bar

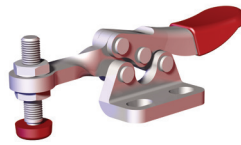

**205-SR** ⓘ  
Right Flanged  
Base, Solid Bar

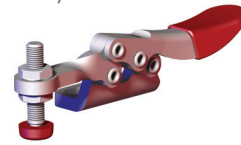

**205-SSS**  
Flanged Base  
Solid Bar, Stainless  
Steel



Note:  
Clamps shown with included accessories.

## Technical Information

Model	Max. Holding Capacity	Clamp Bar Opening (+10°)	Handle Opening (+10°)	Weight	Accessories (Supplied)	
					Spindle Assembly	Flanged Washers
205-U	270N [60 lbf]	90°	80°	0,03kg [0.06lb]	205208-M	105106
205-UB ⓘ						
205-UL ⓘ						
205-UR ⓘ	340N [75 lbf]	94°	82°		205943-M	105906
205-USS						
205-S						
205-SB ⓘ	270N [60 lbf]	94°	82°	205208-M	--	
205-SL ⓘ						
205-SR ⓘ						
205-SSS	340N [75 lbf]				205943-M	

ⓘ This item is available upon request

# 205 SERIES

## Horizontal Hold Down Clamps | Holding Capacities

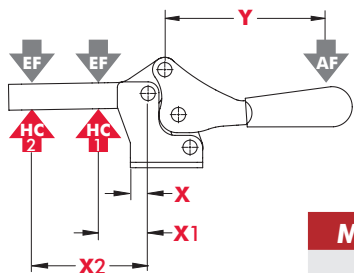

Model	X	X1	X2	Y	±HC1	±HC2	±EF(X1):AF	±EF(X2):AF
U		[0.43] 11			[60lbf.] 270N	[50lbf.] 220N	9:1	5:1
USS	[0.22] 5,6		[0.81] 20,5	[1.31] 33,2	[75lbf.] 340N	[65lbf.] 290N		
S		--			--	[60lbf.] 270N	--	4:1
SSS						[75lbf.] 340N		

Dimensions shown "mm [inch]" ± HC = Holding Capacity, EF = Exerting Force, AF = Applied Force  
Refer to See page MC-TEC-4 for additional information.

## Standard Clamp Dimensions | -U/-UB/-UL-/-UR/-USS/-S/-SB/-SL/-SR/-SSS

**205-U**  
Flanged Base  
U-Bar

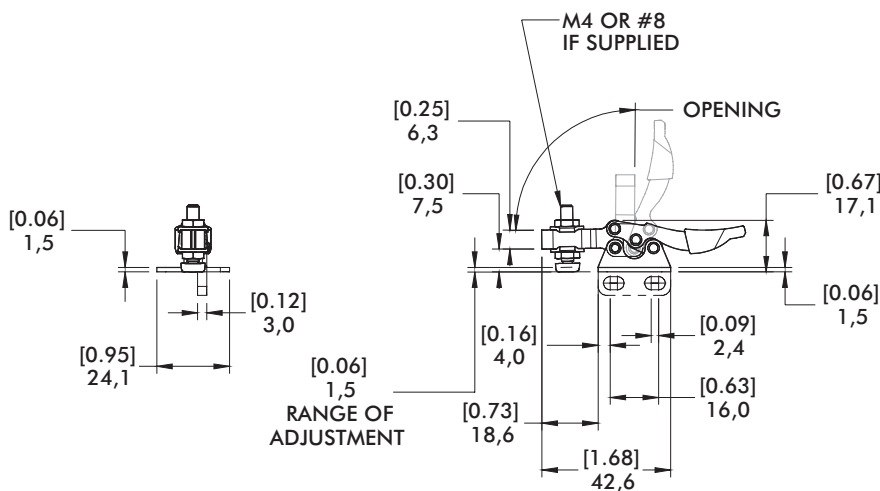
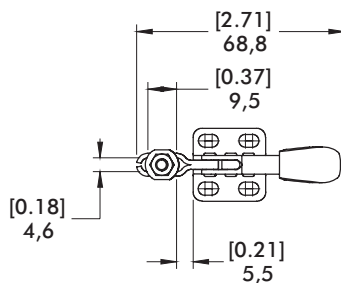
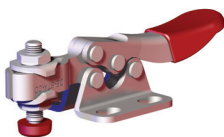

**205-S**  
Flanged Base  
Solid Bar

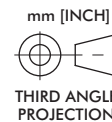
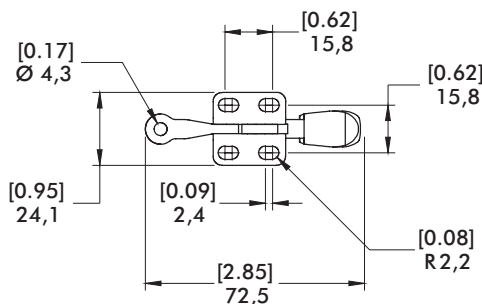
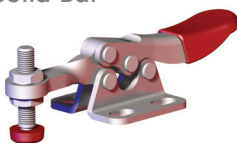

# 215 SERIES

## Horizontal Hold Down Clamps | Product Overview

### Features:

- Low profile
- Stainless steel model furnished without plastic grip

### Applications:

- Assembly
- Checking fixtures
- Closures
- Woodworking

### Also Available:

See page MC-ACC-1 for accessories

Accommodates M6 or 1/4" spindle accessory

**215-U**  
Flanged Base  
U-Bar

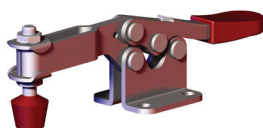

**215-USS**  
Flanged Base  
U-Bar, Stainless  
Steel

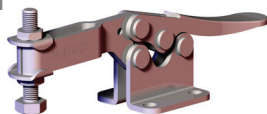

**215-UB** ⓘ  
Straight Base  
U-Bar

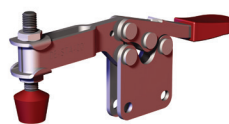

**215-S**  
Flanged Base  
Solid Bar

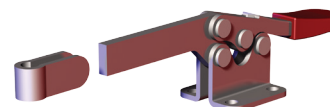

### Note:

Clamps shown with included accessories.

## Technical Information

Model	Max. Holding Capacity	Clamp Bar Opening (+10°)	Handle Opening (+10°)	Weight	Accessories (Supplied)		
					Spindle Assembly	Flanged Washers	Bolt Retainer
215-U	890 N [200 lbf]	87°	78°	0,15kg [0.34lb]	202208-M	215105	--
215-USS	1110 N [250 lbf]				202943-M	215905	
215-UB ⓘ	890 N [200 lbf]	202208-M	215105				
215-S		--	--		205105		

ⓘ This item is available upon request

## Holding Capacities

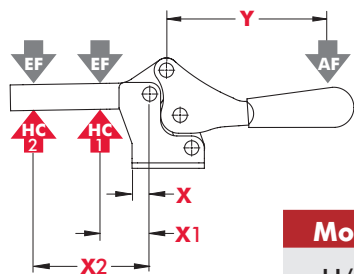

Model	X	X1	X2	Y	±HC1	±HC2	±EF(X1):AF	±EF(X2):AF
U/UB		[1.00] 25,4	[2.25] 57		[200lbf.] 890N	[80lbf.] 360N	9:1	4:1
USS	[0.22] 5,6			[2.72] 69	[250lbf.] 1110N	[110lbf.] 490N		
S		[1.63] 41,4	[2.88] 73		[200lbf.] 890N		6:1	

Dimensions shown "mm [inch]" ± HC = Holding Capacity, EF = Exerting Force, AF = Applied Force  
Refer to See page MC-TEC-4 for additional information.

# 215 SERIES

## Horizontal Hold Down Clamps | Dimensions | -U/-USS/-UB/-S

**215-U**  
Flanged Base  
U-Bar

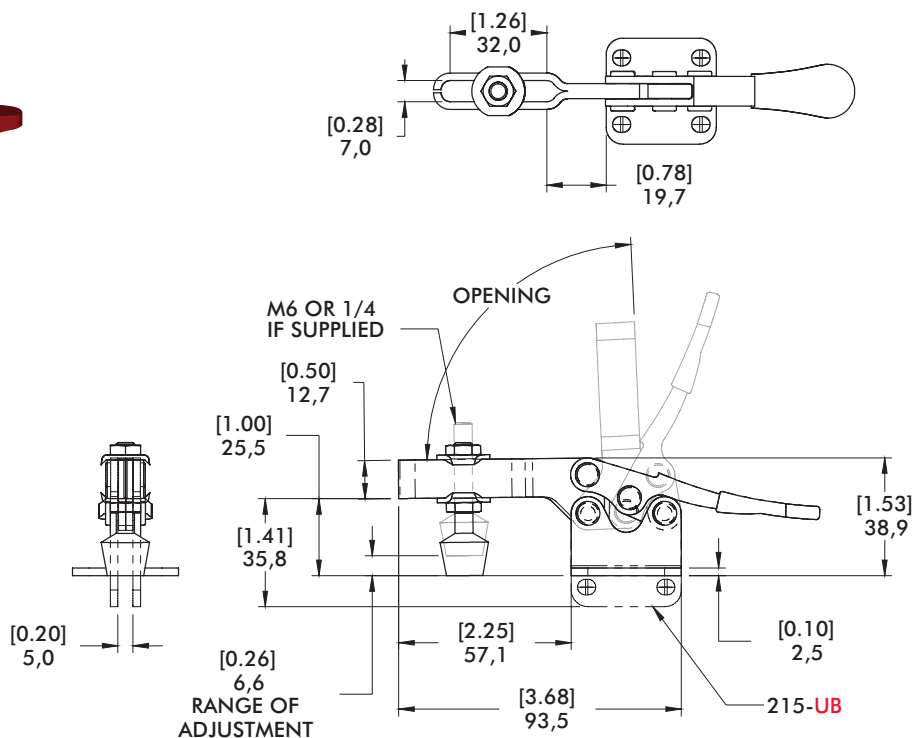
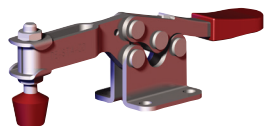

**215-S**  
Flanged Base  
Solid Bar

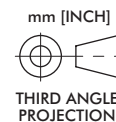
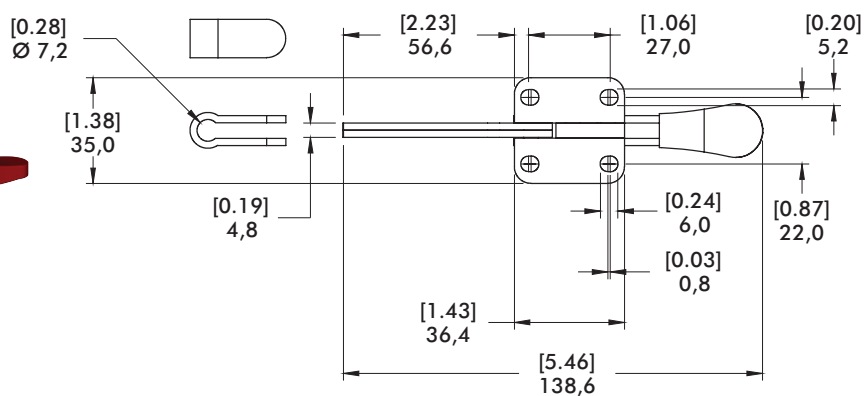
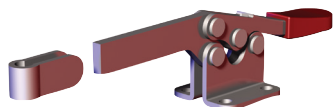

# 225 SERIES

## Horizontal Hold Down Clamps | Product Overview

### Features:

- Low profile
- Stainless steel model furnished without plastic grip
- Available with DE-STA-CO® Toggle Lock Plus

### Applications:

- Assembly
- Checking fixtures
- Closures
- Woodworking

### Also Available:

See page MC-ACC-1 for accessories

Accommodates M8 or  $\frac{5}{16}$ " spindle accessory

Covered under one or more U.S./International Patents

**225-U**  
Flanged Base  
U-Bar



**225-USS**  
Flanged Base, U-Bar,  
Stainless Steel

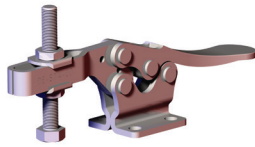

**225-UR**  
Flanged Base, U-Bar  
with DE-STA-CO®  
Toggle Lock  
Plus

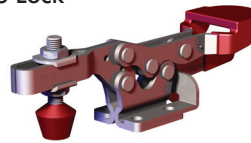

**225-UB** ⓘ  
Straight Base  
U Bar

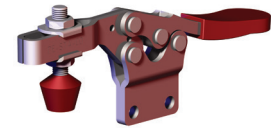

**225-UBSS** ⓘ  
Straight Base, U Bar,  
Stainless Steel

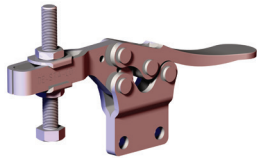

Note:  
Clamps shown with included accessories.

## Technical Information

Model	Max. Holding Capacity	Clamp Bar Opening (+10°)	Handle Opening (+10°)	Weight	Accessories (Supplied)	
					Spindle Assembly	Flanged Washers
225-U	2220 N [500 lbf]	92°	70°	0,25kg [0.55lb]	225208-M	507107
225-USS	2670 N [600 lbf]				207943-M	507907
225-UR	2220 N [500 lbf]			0,31kg [0.69lb]	225208-M	507107
225-UB ⓘ					207943-M	507907
225-UBSS ⓘ	2670 N [600 lbf]			0,25kg [0.55lb]		

ⓘ This item is available upon request

# 225 SERIES

## Horizontal Hold Down Clamps | Holding Capacities

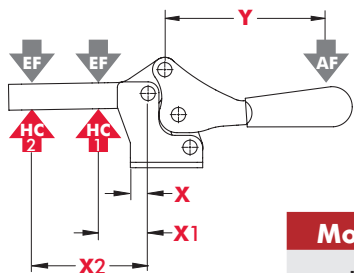

Model	X	X1	X2	Y	±HC1	±HC2	±EF(X1):AF	±EF(X2):AF
U					[500lbf.] 2220N	[250lbf.] 1110N		
USS	[0.12] 3,0	[1.25] 31,8	[2.50] 63,5	[3.56] 90,4	[600lbf.] 2760N	[300lbf.] 1340N	12:1	5:1
UR/UB					[500lbf.] 2220N	[250lbf.] 1110N		
UBSS					[600lbf.] 2760N	[300lbf.] 1340N		

Dimensions shown "mm [inch]" ± HC = Holding Capacity, EF = Exerting Force, AF = Applied Force  
Refer to See page MC-TEC-4 for additional information.

### Dimensions | -U/-USS-/UB-/UBSS

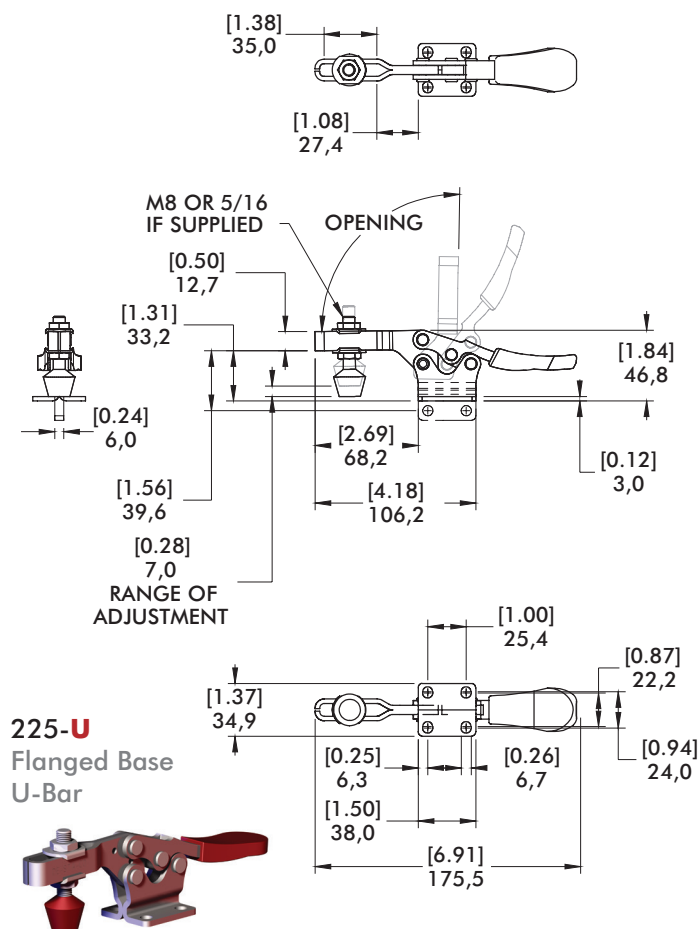

### Dimensions | -UR

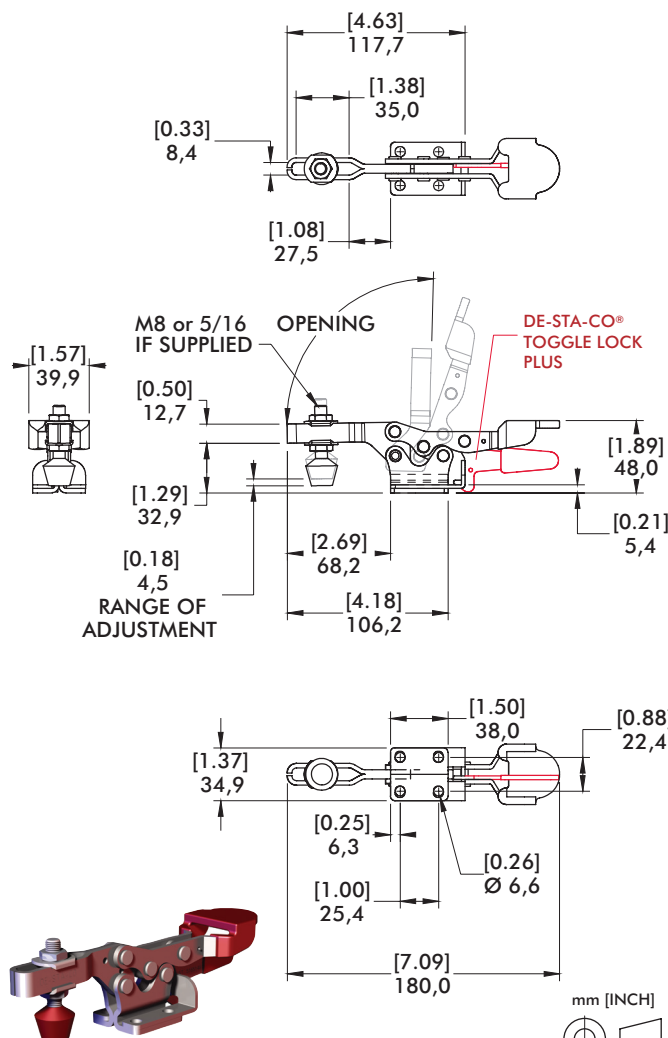



# 235 SERIES

## Horizontal Hold Down Clamps | Product Overview

### Features:

- Low profile
- Available with DE-STA-CO® Toggle Lock Plus
- Available in stainless steel

### Applications:

- Assembly
- Checking fixtures
- Welding
- Closures
- Woodworking

### Also Available:

See page MC-ACC-1 for accessories

Accommodates M10 or 3/8" spindle accessory

Covered under one or more U.S./International Patents

**235-U**  
Flanged Base  
U-Bar

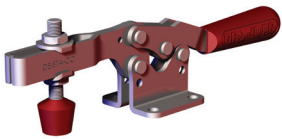

**235-USS**  
Flanged Base, U-Bar,  
Stainless Steel

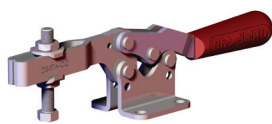

**235-UR**  
Flanged Base, U-Bar  
with DE-STA-CO®  
Toggle Lock  
Plus

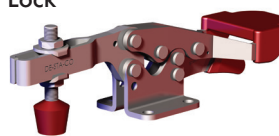

**235-UB①**  
Straight Base  
U-Bar

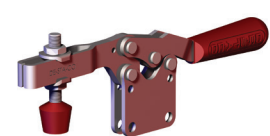

Note:  
Clamps shown with included accessories.

## Technical Information

Model	Max. Holding Capacity	Clamp Bar Opening (+10°)	Handle Opening (+10°)	Weight	Accessories (Supplied)	
					Spindle Assembly	Flanged Washers
235-U	3340 N [750 lbf]	92°	70°	0,67kg [1.47lb]	240208-M	235106
235-USS	3780 N [850 lbf]				237943-M	235906
235-UR	3340 N [750 lbf]			0,74kg [1.64lb]	240208-M	235106
235-UB①				0,67kg [1.47lb]		

① This item is available upon request

## Holding Capacities

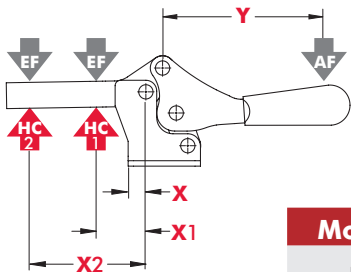

Model	X	X1	X2	Y	‡HC1	‡HC2	‡EF(X1):AF	‡EF(X2):AF
U					[750lbf.] 3340N	[300lbf.] 1330N		
USS	[0.25] 6,4	[1.75] 44,5	[4.13] 105	[5.75] 146	[850lbf.] 3780N	[360lbf.] 1600N	9:1	5:1
UR/UB					[750lbf.] 3340N	[300lbf.] 1330N		

Dimensions shown "mm [inch]" ‡ HC = Holding Capacity, EF = Exerting Force, AF = Applied Force  
Refer to See page MC-TEC-4 for additional information.

# 235 SERIES

## Horizontal Hold Down Clamps | Dimensions | -U/-USS-/UR-/UB

### 235-U Flanged Base U-Bar

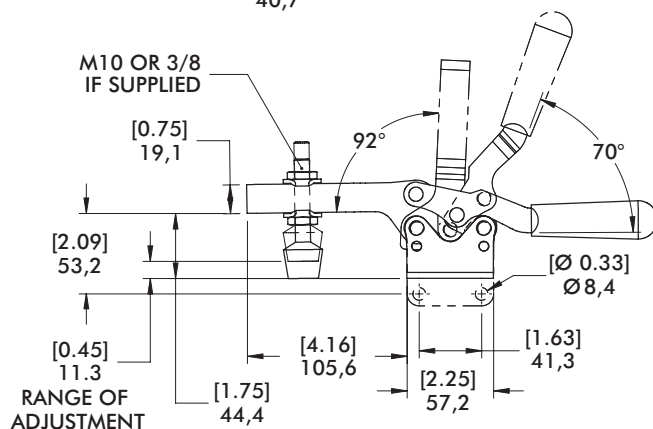
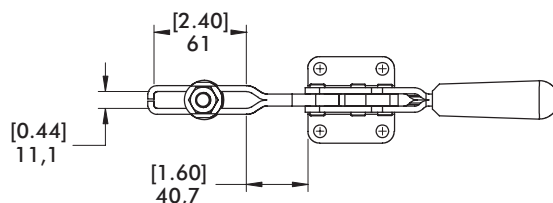
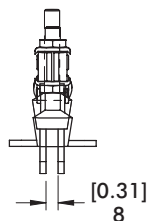
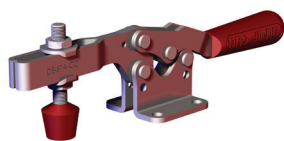

### Dimensions | -UR

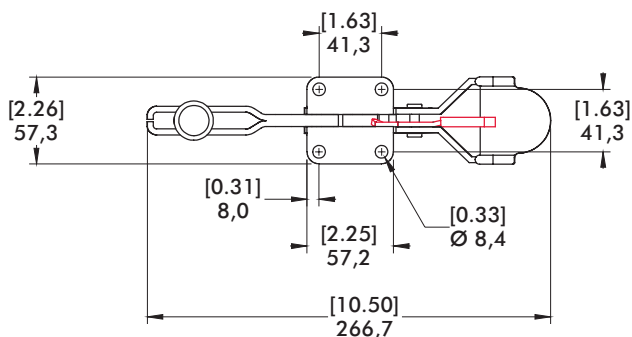
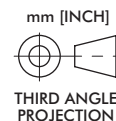
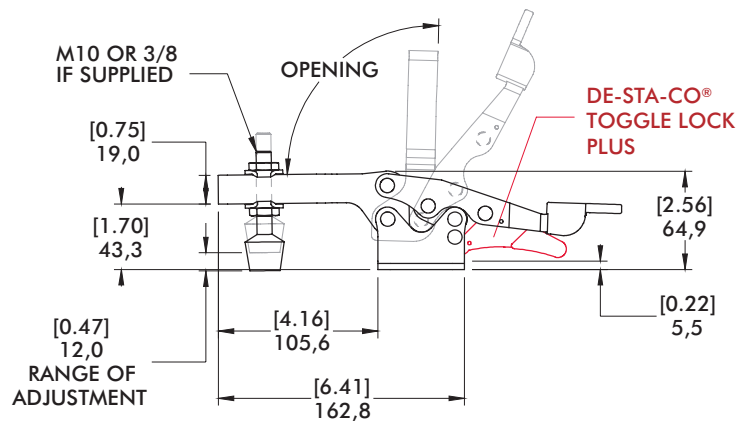
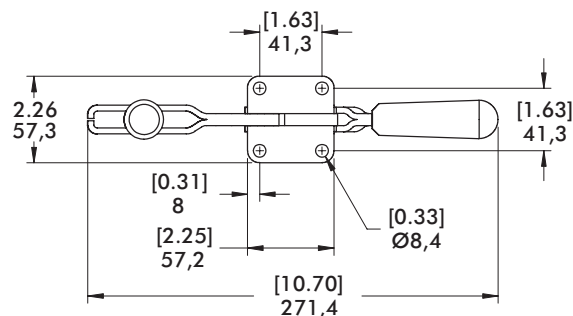
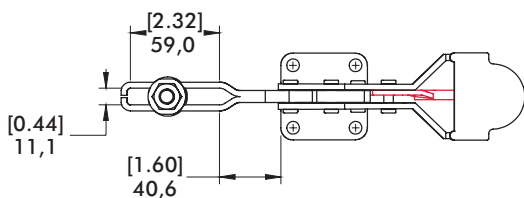

### 235-UR Flanged Base, U-Bar with DE-STA-CO® Toggle Lock Plus

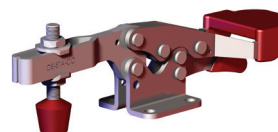

# 305, 307, 309 SERIES

## Horizontal Hold Down Clamps | Product Overview

### Features:

- Compact design suitable for use in confined spaces
- Available with DE-STA-CO® Toggle Lock Plus
- Stainless steel models available

### Applications:

- Assembly & Test
- Light Machining
- Closures
- Woodworking

### Also Available:

See page MC-ACC-1 for accessories

**305-U**  
Flanged Base  
U-Bar

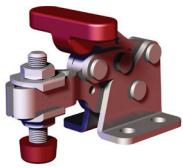

**305-USS**  
Flanged Base  
U-Bar, Stainless  
Steel

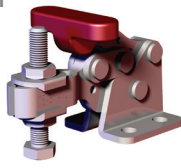

**305-UR**  
Flanged Base,  
U-Bar with  
DE-STA-CO®  
Toggle  
Lock  
Plus

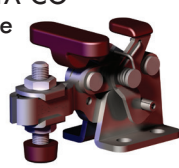

**307-U**  
Flanged Base  
U-Bar

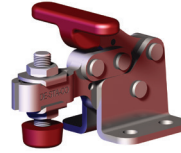

**307-USS**  
Flanged Base  
U-Bar, Stainless  
Steel

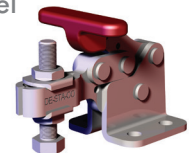

**307-UR**  
Flanged Base,  
U-Bar with  
DE-STA-CO®  
Toggle  
Lock  
Plus



**309-U**  
Flanged Base  
U-Bar

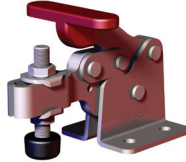

**309-USS**  
Flanged Base  
U-Bar, Stainless  
Steel

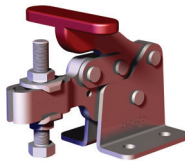

**309-UR ⓘ**  
Flanged Base,  
U-Bar with  
DE-STA-CO®  
Toggle  
Lock  
Plus

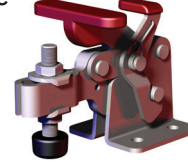

Note:  
Clamps shown with included accessories.

## Technical Information

Model	Max. Holding Capacity	Clamp Bar Opening (+10°)	Handle Opening (+10°)	Weight	Accessories (Supplied)	
					Spindle Assembly	Flanged Washers
305-U	670 N [150 lbf]	90°	170°	0,06kg [0.13lb]	305208-M	102111
305-USS	900 N [200 lbf]				201943-M	102911
305-UR	670 N [150 lbf]				305208-M	102111
307-U	1560 N [350 lbf]	92°	173°	0,24kg [0.54lb]	307208-M	507107
307-USS					207943-M	507907
307-UR					307208-M	507107
309-U	3340 N [750 lbf]	90°	168°	1,30kg [0.59lb]	309208	235106
309-USS					237943-M	235906
309-UR ⓘ					309208	235106

ⓘ This item is available upon request

# 305, 307, 309 SERIES

## Horizontal Hold Down Clamps | Holding Capacities

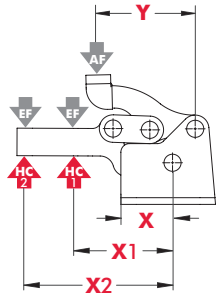

Model	X	X1	X2	Y	±HC1	±HC2	±EF(X1):AF	±EF(X2):AF
305-U/UR	[0.58] 14,6	[1.38] 35	[1.88] 47,7	[1.14] 29	[150lbf.] 670N	[110lbf.] 490N	3:1	2:1
305-USS					[200lbf.] 900N	[150lbf.] 670N		
307-U/UR/USS	[0.94] 24	[1.88] 47,7	[2.50] 63,5	[1.77] 45	[350lbf.] 1560N	[260lbf.] 1160N	4:1	
309-U/UR/USS	[1.34] 34	[2.50] 63,5	[3.50] 89	[2.70] 68,5	[750lbf.] 3340N	[530lbf.] 2360N		

Dimensions shown "mm [inch]" ±HC = Holding Capacity, EF = Exerting Force, AF = Applied Force  
Refer to See page MC-TEC-4 for additional information.

### Dimensions | -U/-USS/-UR

**305-U**  
Flanged Base  
U-Bar

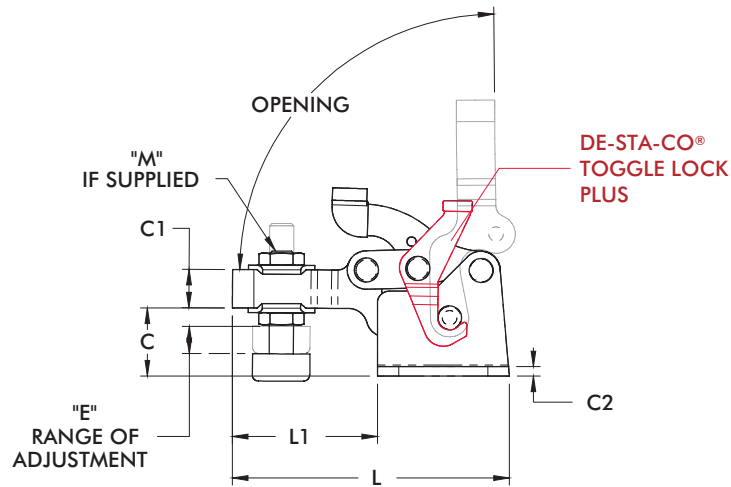
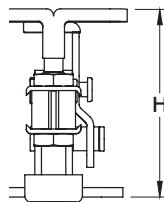
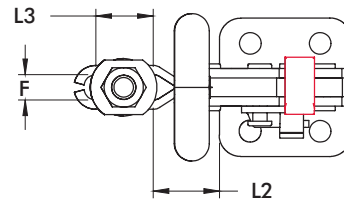
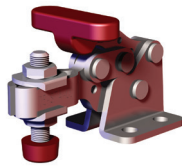

**307-UR**  
Flanged Base,  
U-Bar with  
DE-STA-CO®  
Toggle  
Lock  
Plus

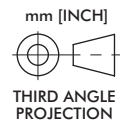
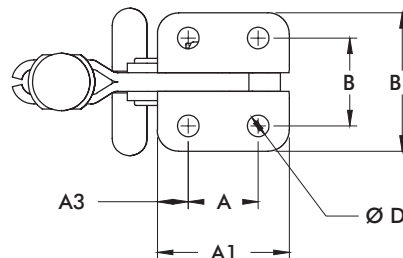
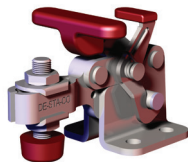

Model	A	A1	A3	B	B1	C	C1	C2	D	E	F	H	L	L1	L2	L3	M
305-U/UR	[0.53] 13,5	[1.035] 26,3	[0.25] 6,4	[0.63] 16,0	[1.02] 25,9	[0.48] 12,2	[0.31] 7,9	[0.08] 2,0	[0.18] 4,6	[0.31] 8	[0.21] 5,3	[1.43] 36,3	[2.21] 56,1	[1.19] 30,2	[0.51] 13,0	[0.50] 12,7	[#10] M5
307-U/UR	[0.91] 23,1	[1.72] 43,7	[0.40] 10,2	[1.14] 29,0	[1.80] 45,7	[0.89] 22,6	[0.50] 12,7	[0.12] 3,0	[0.28] 7,1	[0.37] 9,5	[0.33] 8,4	[2.36] 59,9	[3.61] 91,7	[1.89] 48,0	[0.86] 21,8	[0.75] 19,1	[5/16] M8
309-U/UR	[1.38] 35,1	[2.52] 64,0	[0.58] 14,7	[1.50] 38,1	[2.47] 62,7	[1.31] 33,3	[0.75] 19,1	[0.12] 3,0	[0.33] 8,4	[0.72] 18,5	[0.44] 10,4	[3.53] 89,7	[5.19] 131,8	[2.68] 68,1	[1.28] 32,5	[1.06] 26,9	[3/8-16] M10

# 206 SERIES

## Horizontal Hold Down Clamps | Product Overview

### Features:

- All stainless steel construction
- Offers good bar clearance under clamping bar while maintaining low profile

### Applications:

- Assembly
- Chemical processing
- Closures
- Light duty clamping

### Also Available:

See page MC-ACC-1 for accessories

Accommodates M4 or #8 spindle accessory

#### 206-SS

Flanged Base  
Low U-Bar,  
Stainless Steel

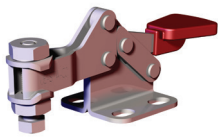

#### 206-HSS

Flanged Base  
High U-Bar,  
Stainless Steel

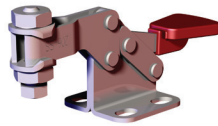

## Technical Information

Model	Max. Holding Capacity	Clamp Bar Opening (+10°)	Handle Opening (+10°)	Weight	Accessories (Supplied)	
					Spindle Assembly	Flanged Washers
206-SS	440 N [100 lbf]	90°	90°	0,03kg [0.07lb]	205943-M	105906
206-HSS						

Model 206-HSS shown securing a platen on a prototyping machine.

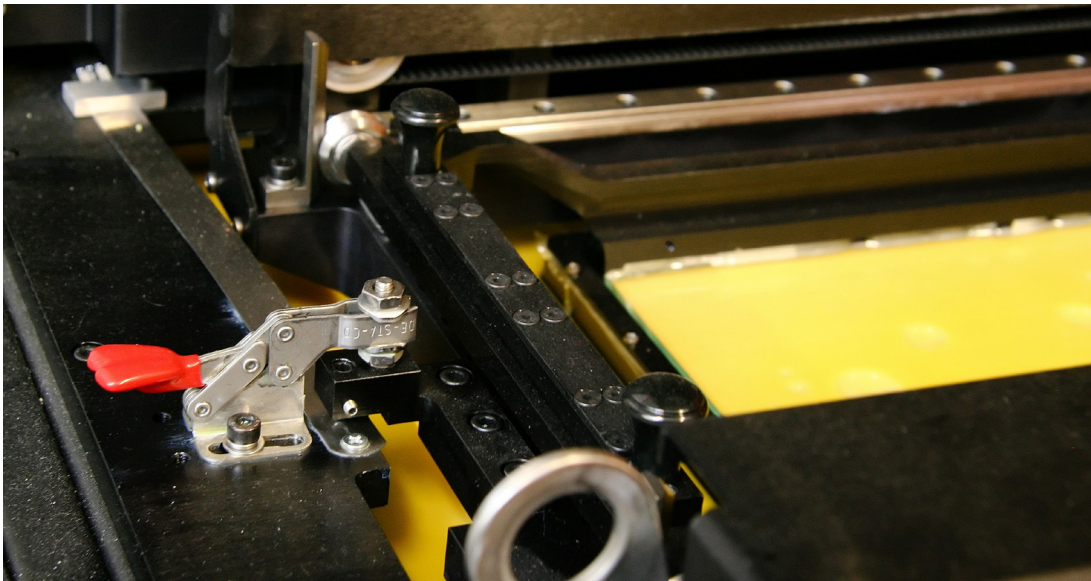

# 206 SERIES

## Horizontal Hold Down Clamps | Holding Capacities

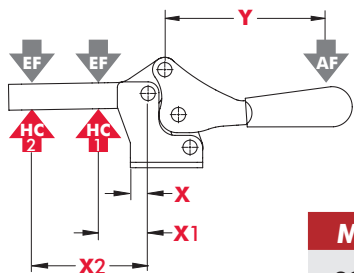

Model	X	X1	X2	Y	±HC1	±HC2	±EF(X1):AF	±EF(X2):AF
SS/HSS	[0.20] 5	[0.43] 11	[1.06] 27	[1.14] 29	[100lbf.] 440N	[50lbf.] 220N	5:1	3:1

Dimensions shown "mm [inch]" ± HC = Holding Capacity, EF = Exerting Force, AF = Applied Force  
Refer to See page MC-TEC-4 for additional information.

## Dimensions | -SS/-HSS

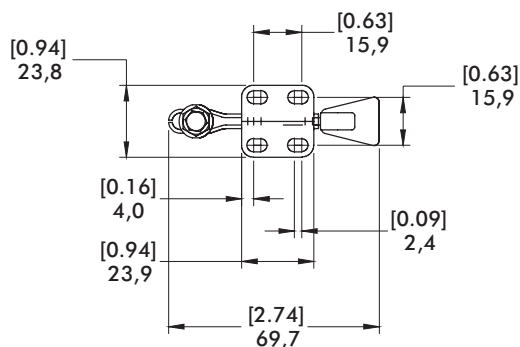
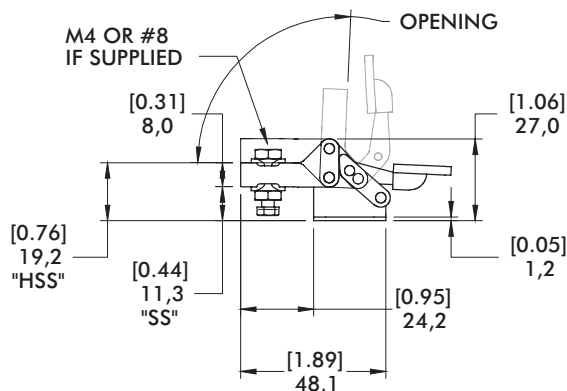
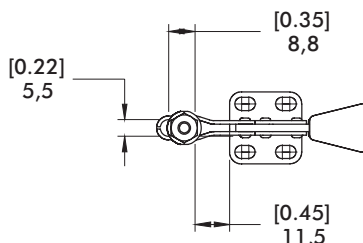
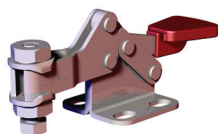

# 5305, 5310 SERIES

## Heavy Duty Horizontal Hold Down Clamps | Product Overview

### Features:

- Solid clamping arm may be modified to suit requirements
- Hardened steel pivot pins and bushings provide long life
- Black oxide finish
- DE-STA-CO® Toggle Lock Plus versions available†

### Applications:

- Welding fixtures
- Assembly fixtures
- Light machining

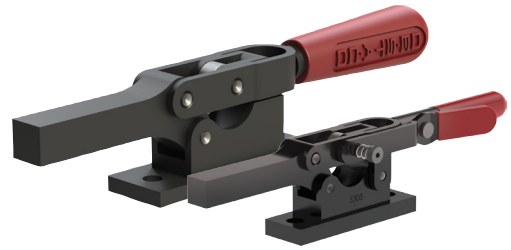

**5305/5310**  
Flanged Base

**5305-B/5310-B**  
Solid Base

**5305-R/5310-R**  
Flanged Base with DE-STA-CO® Toggle Lock Plus

**5305-BR†/5310-BR†**  
Solid Base with DE-STA-CO® Toggle Lock Plus

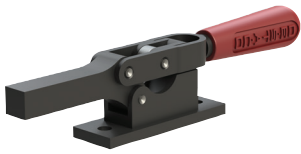

## Technical Information

Model	Max. Holding Capacity	Clamp Bar Opening (+10°)	Handle Opening (+10°)	Weight
5305	[600lbf.] 2670N	90°	69°	[1.08lbs] 0,49kg
5305-B				[0.82lbs] 0,37kg
5305-R				[1.09lbs] 0,49kg
5305-BR†				[0.83lbs] 0,37kg
5310	[1300lbf.] 5780N	90°	69°	[2.84lbs] 1,29kg
5310-B				[2.24lbs] 1,02kg
5310-R				[2.87lbs] 1,30kg
5310-BR†				[2.27lbs] 1,03kg

† This item is available upon request.

† Toggle Lock Plus locks the handle in the closed position only.

# 5305, 5310 SERIES

## Heavy Duty Horizontal Hold Down Clamps | Dimensions

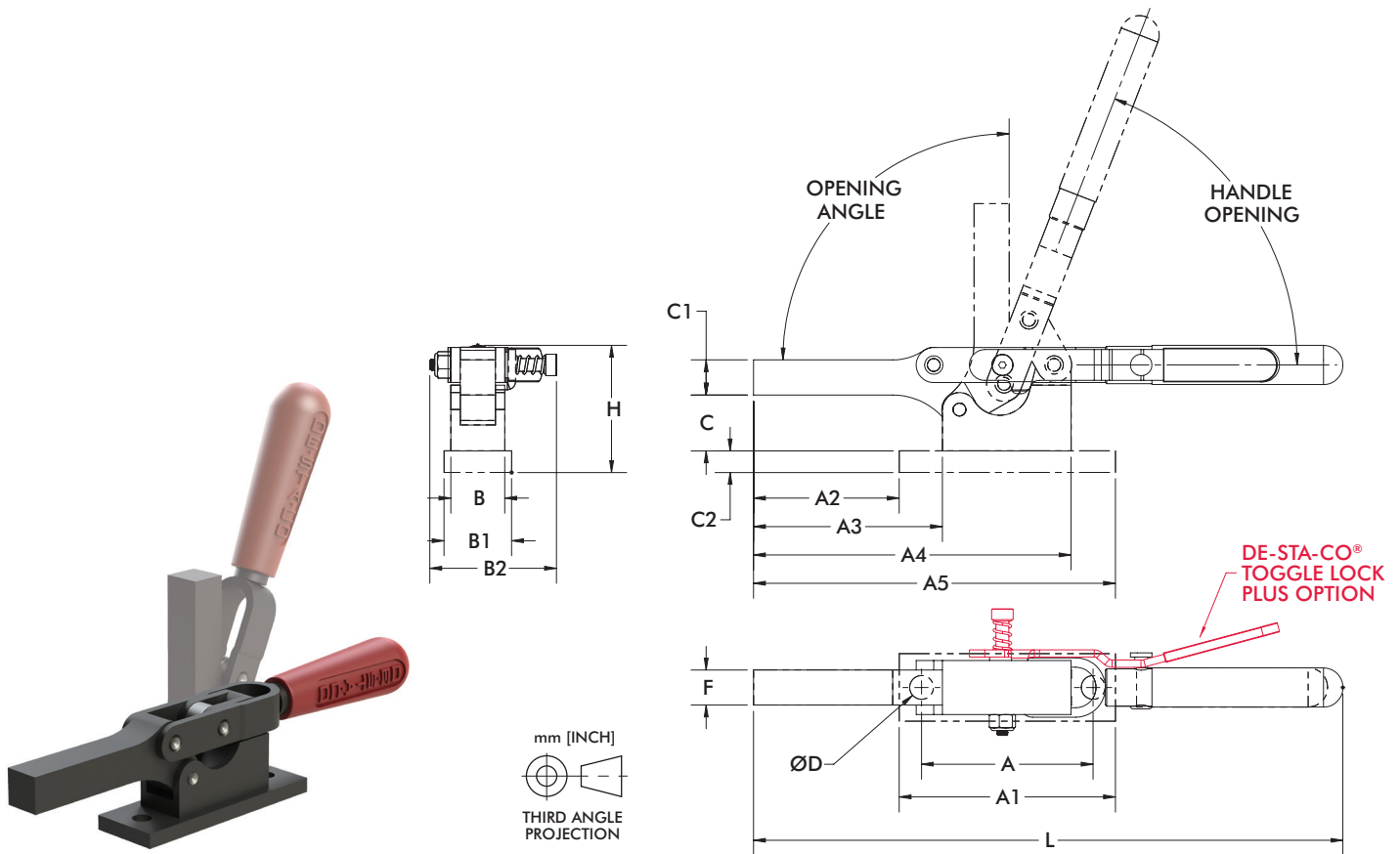

Model	A	A1	A2	A3	A4	A5	B	B1	B2	C	C1	C2	D	F	H	L
5305	[2.50] 63,5	[3.15] 80,0	[2.12] 53,8	[2.75] 69,9	[4.63] 117,6	[5.27] 133,9	[0.79] 20,1	[0.98] 24,9	--	[0.81] 20,6	[0.51] 13,0	[0.31] 7,9	[0.35] 8,9	[0.51] 13,0	[1.51] 38,4	[8.36] 212,4
5305-R									[1.84] 46,7							
5310	[3.63] 92,2	[4.63] 117,6	[2.63] 66,8	[3.63] 92,2	[6.25] 158,8	[7.25] 184,2	[1.13] 28,7	[1.50] 38,1	--	[1.00] 25,4	[0.75] 19,1	[0.31] 7,9	[0.41] 10,4	[0.79] 20,1	[2.00] 50,8	[11.13] 282,6
5310-R									[2.31] 58,7							[11.02] 279,8

Model	A3	A4	B2	C	C1	F	H	L
5305-B	[2.75] 69,9	[4.63] 117,6	--	[0.81] 20,6	[0.51] 13,0	[0.51] 13,0	[1.51] 38,4	[8.36] 212,4
5305-BR ⓘ			[1.84] 46,7					
5310-B	[3.63] 92,2	[6.25] 158,8	--	[1.00] 25,4	[0.75] 19,1	[0.79] 20,1	[2.00] 50,8	[11.13] 282,6
5310-BR ⓘ			[2.31] 58,7					[11.02] 279,8

ⓘ This item is available upon request