



Star Grips

with plain steel bushing

INCH Parts
METRIC Parts

Style H
reamed blind hole

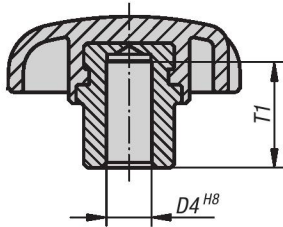

Style K
tapped blind hole

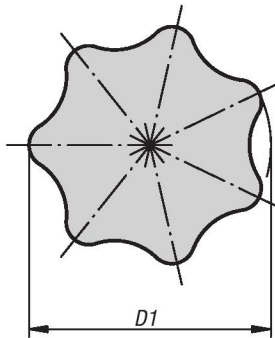
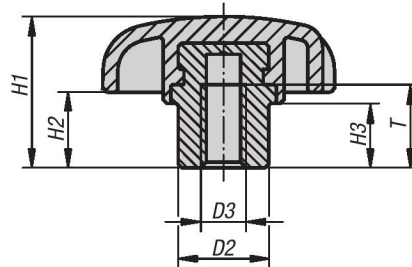

Material:

Black thermoplastic.

Steel quality class 5.8 or stainless steel 1.4305.

Type:

Steel parts blue chromate or stainless steel natural finish.

Part Number Example:

K0153.1CL

Note:

Star Grips with plain steel bushing are particularly suitable for cross pin and set screw applications.

KIPP Star Grips, with plain steel bushing, style H, inch

Item No.	Style	D4	T1	D1	D2	H1	H2	H3
K0153.1CL	H	.188	9.5	25	10	16	8	6
K0153.1CM	H	.250	12	32	12	20	10	8.5
K0153.1CM1	H	.250	14	40	13.5	25	13	10
K0153.1CN	H	.312	14	40	13.5	25	13	10
K0153.1CN1	H	.312	18	50	19	32	17	12
K0153.1CO	H	.375	18	50	19	32	17	12
K0153.1CO1	H	.375	22	63	19	40	21	15
K0153.1CP	H	.500	22	63	19	40	21	15
K0153.1CQ	H	.625	22	63	23	40	21	15

KIPP Star Grips, with plain steel bushing, style K, inch

Item No.	Style	D3	T	D1	D2	H1	H2	H3
K0153.2A1	K	10-32	8.5	25	10	16	8	6
K0153.2A2	K	1/4-20	12	32	12	20	10	8.5
K0153.2A21	K	1/4-20	14	40	13.5	25	13	10
K0153.2A3	K	5/16-18	14	40	13.5	25	13	10
K0153.2A31	K	5/16-18	18	50	19	32	17	12
K0153.2A4	K	3/8-16	18	50	19	32	17	12
K0153.2A41	K	3/8-16	22	63	19	40	21	15
K0153.2A5	K	1/2-13	22	63	19	40	21	15
K0153.2A6	K	5/8-11	22	63	23	40	21	15



Star Grips

with plain steel bushing

KIPP Star Grips, with plain steel bushing, style H, metric

Item No.	Version	Style	D4	T1	D1	D2	H1	H2	H3
K0153.105	bushing steel	H	5	9,5	25	10	16	8	6
K0153.106	bushing steel	H	6	12	32	12	20	10	8,5
K0153.1061	bushing steel	H	6	14	40	13,5	25	13	10
K0153.108	bushing steel	H	8	14	40	13,5	25	13	10
K0153.1081	bushing steel	H	8	18	50	19	32	17	12
K0153.110	bushing steel	H	10	18	50	19	32	17	12
K0153.1101	bushing steel	H	10	22	63	19	40	21	15
K0153.112	bushing steel	H	12	22	63	19	40	21	15
K0153.116	bushing steel	H	16	22	63	23	40	21	15

KIPP Star Grips, with plain steel bushing, style K, metric

Item No.	Version	Style	D3	T	D1	D2	H1	H2	H3
K0153.205	bushing steel	K	M5	8,5	25	10	16	8	6
K0153.206	bushing steel	K	M6	12	32	12	20	10	8,5
K0153.2061	bushing steel	K	M6	14	40	13,5	25	13	10
K0153.208	bushing steel	K	M8	14	40	13,5	25	13	10
K0153.2081	bushing steel	K	M8	18	50	19	32	17	12
K0153.210	bushing steel	K	M10	18	50	19	32	17	12
K0153.2101	bushing steel	K	M10	22	63	19	40	21	15
K0153.212	bushing steel	K	M12	22	63	19	40	21	15
K0153.216	bushing steel	K	M16	22	63	23	40	21	15
K0153.305	bushing stainless steel	K	M5	8,5	25	10	16	8	6
K0153.306	bushing stainless steel	K	M6	12	32	12	20	10	8,5
K0153.3061	bushing stainless steel	K	M6	14	40	13,5	25	13	10
K0153.308	bushing stainless steel	K	M8	14	40	13,5	25	13	10
K0153.3081	bushing stainless steel	K	M8	18	50	19	32	17	12
K0153.310	bushing stainless steel	K	M10	18	50	19	32	17	12
K0153.3101	bushing stainless steel	K	M10	22	63	19	40	21	15
K0153.312	bushing stainless steel	K	M12	22	63	19	40	21	15
K0153.316	bushing stainless steel	K	M16	22	63	23	40	21	15