

Star Grips

gray cast iron DIN 6336

METRIC Parts INCH Parts



Style A blank

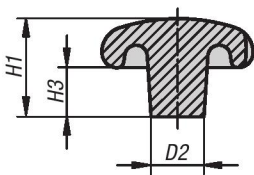

Style B reamed through hole

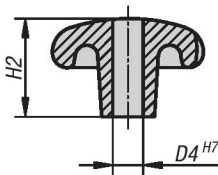

Style C reamed blind hole

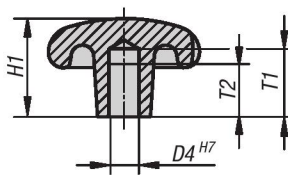

Style D tapped with counter bore

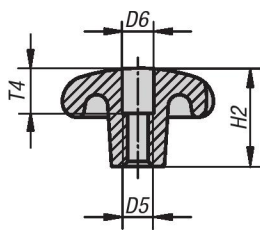
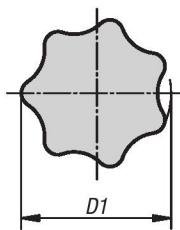

Style E tapped blind hole

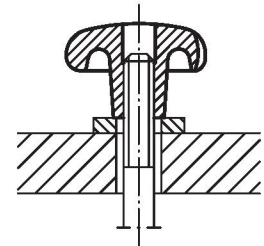
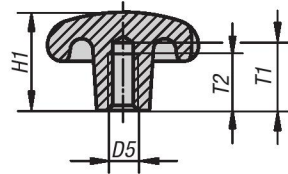

Material:

Gray cast iron GJL 200

Type:

All styles have a natural tumbled finish.

Part Number Example:

K0151.2CM

On request:

Gray Cast Iron Star Grips black powder-coated.

KIPP Star Grips gray cast iron DIN 6336, style B, inch

Item No.	Style	Version	D1	D2	D4	H2	H3
K0151.2CM	B	tumbled	32	12	.250	20	10
K0151.2CN	B	tumbled	40	14	.312	25	13
K0151.2CO	B	tumbled	50	18	.375	32	17
K0151.2CP	B	tumbled	63	20	.500	40	21
K0151.2CQ	B	tumbled	80	25	.625	50	25

KIPP Star Grips gray cast iron DIN 6336, inch

Item No. Style C	Item No. Style D	Item No. Style E	Version	D1	D2	D4	D5	D6	H1	H2	H3	T1	T2	T4
K0151.3CM	K0151.4A2	K0151.5A2	tumbled	32	12	.250/-/	- 1 1/4-20 5/8-11	-.6.4/-	21/-/52	-/20/-	10	-/15/32	-/12/28	-/10/-
K0151.3CN	K0151.4A3	K0151.5A3	tumbled	40	14	.312/-/	- 1 5/16-18 5/16-18	-.8.4/-	26/-/26	-/25/-	13	-/18/18	-/15/15	-/12/-
K0151.3CO	K0151.4A4	K0151.5A4	tumbled	50	18	.375/-/	- 1 3/8-16 3/8-16	-/10.5/-	34/-/34	-/32/-	17	-/21/21	-/18/18	-/16/-
K0151.3CP	K0151.4A5	K0151.5A5	tumbled	63	20	.500/-/	- 1 1/2-13 1/2-13	-/13/-	42/-/42	-/40/-	21	-/25/25	-/22/22	-/20/-
K0151.3CQ	K0151.4A6	K0151.5A6	tumbled	80	25	.625/-/	- 1 5/8-11 5/8-11	-/17/-	52/-/52	-/50/-	25	-/32/32	-/28/28	-/30/-

Star Grips

gray cast iron DIN 6336



KIPP Star Grips gray cast iron DIN 6336, metric

Item No. Style A	Item No. Style B	Version	D1	D2	D4	H1	H2	H3
K0151.106	K0151.206	tumbled	32	12	-/6	21/-	-/20	10
K0151.108	K0151.208	tumbled	40	14	-/8	26/-	-/25	13
K0151.110	K0151.210	tumbled	50	18	-/10	34/-	-/32	17
K0151.112	K0151.212	tumbled	63	20	-/12	42/-	-/40	21
K0151.116	K0151.216	tumbled	80	25	-/16	52/-	-/50	25

KIPP Star Grips gray cast iron DIN 6336, metric

Item No. Style C	Item No. Style D	Item No. Style E	Version	D1	D2	D4	D5	D6	H1	H2	H3	T1	T2	T4
K0151.306	K0151.406	K0151.506	tumbled	32	12	6/-/	-/M6/M6	-/6,4/-	21/-/21	-/20/-	10	15/-/15	12/-/12	-/10/-
K0151.308	K0151.408	K0151.508	tumbled	40	14	8/-/	-/M8/M8	-/8,4/-	26/-/26	-/25/-	13	18/-/18	15/-/15	-/12/-
K0151.310	K0151.410	K0151.510	tumbled	50	18	10/-/	-/M10/M10	-/10,5/-	34/-/34	-/32/-	17	21/-/21	18/-/18	-/16/-
K0151.312	K0151.412	K0151.512	tumbled	63	20	12/-/	-/M12/M12	-/13/-	42/-/42	-/40/-	21	25/-/25	22/-/22	-/20/-
K0151.316	K0151.416	K0151.516	tumbled	80	25	16/-/	-/M16/M16	-/17/-	52/-/52	-/50/-	25	32/-/32	28/-/28	-/30/-