



Knurled Wheels

internal components steel

INCH
Parts



Style D
tapped through hole
without cap

Style K
tapped through hole
with cap

Style E
reamed through hole
without cap

Style H
reamed through hole
with cap

Style L
with external thread

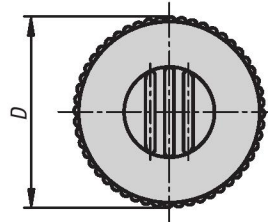
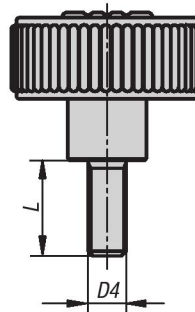
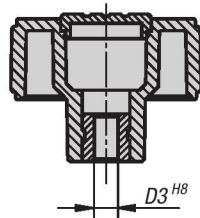
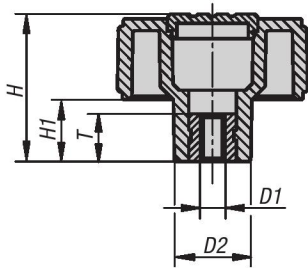

Novo-Grip Knurled Wheels are ergonomic, eye appealing, durable and offer a firm and safe grip. Ideal for all applications. Strength and durability are guaranteed with Novo-Grip Knurled Wheels.

Material:

Thermoplastic, bushing and threaded bolt in steel quality class 5.8.

Type:

Steel blue chromate.

Part Number Example:

K0260.41067 (wheel cap color bright yellow)

Note:

Δ Add the desired wheel cap color here; no color code is required with black gray wheel caps



KIPP Knurled Wheels, internal thread, inch

Item No.	Style	Version	Size	D	D1	D2	H	H1	T
K0260.11A1	D	bushing steel	1	40	10-32	16.5	31	13	10
K0260.11A2	D	bushing steel	1	40	1/4-20	16.5	31	13	10
K0260.11A3	D	bushing steel	1	40	5/16-18	16.5	31	13	14
K0260.12A3	D	bushing steel	2	50	5/16-18	18	36	15	14
K0260.12A4	D	bushing steel	2	50	3/8-16	18	36	15	14
K0260.13A4	D	bushing steel	3	63	3/8-16	22	41	17	14
K0260.13A5	D	bushing steel	3	63	1/2-13	22	41	17	18



Knurled Wheels

internal components steel

KIPP Knurled Wheels, internal thread, inch

Item No.	Style	Version	Size	D	D1	D2	H	H1	T
K0260.21A1Δ	K	bushing steel	1	40	10-32	16.5	31	13	10
K0260.21A2Δ	K	bushing steel	1	40	1/4-20	16.5	31	13	10
K0260.21A3Δ	K	bushing steel	1	40	5/16-18	16.5	31	13	14
K0260.22A3Δ	K	bushing steel	2	50	5/16-18	18	36	15	14
K0260.22A4Δ	K	bushing steel	2	50	3/8-16	18	36	15	14
K0260.23A4Δ	K	bushing steel	3	63	3/8-16	22	41	17	14
K0260.23A5Δ	K	bushing steel	3	63	1/2-13	22	41	17	18

KIPP Knurled Wheels, with bushing, inch

Item No.	Style	Version	Size	D	D2	D3	H	H1	T
K0260.31CM	E	bushing steel	1	40	16.5	.250	31	13	10
K0260.32CN	E	bushing steel	2	50	18	.312	36	15	14
K0260.33CO	E	bushing steel	3	63	22	.375	41	17	14

KIPP Knurled Wheels, with bushing, inch

Item No.	Style	Version	Size	D	D2	D3	H	H1	T
K0260.41CMA	H	bushing steel	1	40	16.5	.250	31	13	10
K0260.42CNA	H	bushing steel	2	50	18	.312	36	15	14
K0260.43COA	H	bushing steel	3	63	22	.375	41	17	14

KIPP Knurled Wheels, external thread, inch

Item No.	Style	Version	Size	D	D2	D4	H	H1	L
K0260.51A1ΔX	L	bolt steel	1	40	16.5	10-32	31	13	10/20
K0260.51A2ΔX	L	bolt steel	1	40	16.5	1/4-20	31	13	20/30
K0260.51A3ΔX	L	bolt steel	1	40	16.5	5/16-18	31	13	20/40
K0260.52A3ΔX	L	bolt steel	2	50	18	5/16-18	36	15	20/40
K0260.52A4ΔX	L	bolt steel	2	50	18	3/8-16	36	15	20/40
K0260.53A4ΔX	L	bolt steel	3	63	22	3/8-16	41	17	20/40
K0260.53A5ΔX	L	bolt steel	3	63	22	1/2-13	41	17	30/60



Knurled Wheels

internal components steel

METRIC
Parts



Style D
tapped through hole
without cap

Style K
tapped through hole
with cap

Style E
reamed through hole
without cap

Style H
reamed through hole
with cap

Style L
with external thread

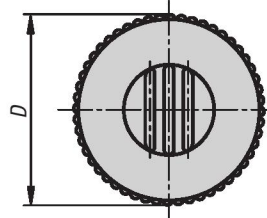
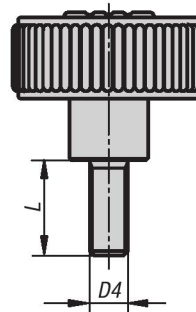
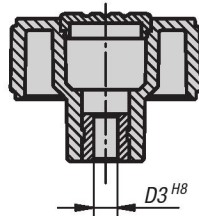
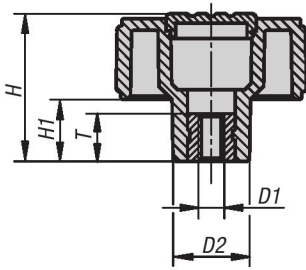

Novo-Grip Knurled Wheels are ergonomic, eye appealing, durable and offer a firm and safe grip. Ideal for all applications. Strength and durability are guaranteed with Novo-Grip Knurled Wheels.

Material:

Thermoplastic, bushing and threaded bolt in steel quality class 5.8.

Type:

Steel blue chromate.

Part Number Example:

K0260.41067 (wheel cap color bright yellow)

Note:

Δ Add the desired wheel cap color here; no color code is required with black gray wheel caps



KIPP Knurled Wheels, internal thread, metric

Item No.	Style	Version	Size	D	D1	D2	H	H1	T
K0260.1105	D	bushing steel	1	40	M5	16,5	31	13	10
K0260.1106	D	bushing steel	1	40	M6	16,5	31	13	10
K0260.1108	D	bushing steel	1	40	M8	16,5	31	13	14
K0260.1208	D	bushing steel	2	50	M8	18	36	15	14
K0260.1210	D	bushing steel	2	50	M10	18	36	15	14
K0260.1310	D	bushing steel	3	63	M10	22	41	17	14
K0260.1312	D	bushing steel	3	63	M12	22	41	17	18



Knurled Wheels

internal components steel

KIPP Knurled Wheels, internal thread, metric

Item No.	Style	Version	Size	D	D1	D2	H	H1	T
K0260.2105Δ	K	bushing steel	1	40	M5	16,5	31	13	10
K0260.2106Δ	K	bushing steel	1	40	M6	16,5	31	13	10
K0260.2108Δ	K	bushing steel	1	40	M8	16,5	31	13	14
K0260.2208Δ	K	bushing steel	2	50	M8	18	36	15	14
K0260.2210Δ	K	bushing steel	2	50	M10	18	36	15	14
K0260.2310Δ	K	bushing steel	3	63	M10	22	41	17	14
K0260.2312Δ	K	bushing steel	3	63	M12	22	41	17	18

KIPP Knurled Wheels, with bushing, metric

Item No.	Style	Version	Size	D	D2	D3	H	H1	T
K0260.3106	E	bushing steel	1	40	16,5	6	31	13	10
K0260.3208	E	bushing steel	2	50	18	8	36	15	14
K0260.3310	E	bushing steel	3	63	22	10	41	17	14

KIPP Knurled Wheels, with bushing, metric

Item No.	Style	Version	Size	D	D2	D3	H	H1	T
K0260.4106Δ	H	bushing steel	1	40	16,5	6	31	13	10
K0260.4208Δ	H	bushing steel	2	50	18	8	36	15	14
K0260.4310Δ	H	bushing steel	3	63	22	10	41	17	14

KIPP Knurled Wheels, external thread, metric

Item No.	Style	Version	Size	D	D2	D4	H	H1	L
K0260.5105ΔX	L	bolt steel	1	40	16,5	M5	31	13	10/20/40
K0260.5106ΔX	L	bolt steel	1	40	16,5	M6	31	13	10/20/40
K0260.5108ΔX	L	bolt steel	1	40	16,5	M8	31	13	15/30/60
K0260.5208ΔX	L	bolt steel	2	50	18	M8	36	15	15/30/60
K0260.5210ΔX	L	bolt steel	2	50	18	M10	36	15	20/30/60
K0260.5310ΔX	L	bolt steel	3	63	22	M10	41	17	20/30/60
K0260.5312ΔX	L	bolt steel	3	63	22	M12	41	17	30/60