



Star Grips

in stainless steel similar to DIN 6336



Style B
reamed through hole

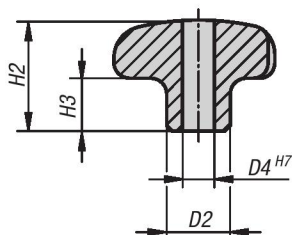

Style C
reamed blind hole

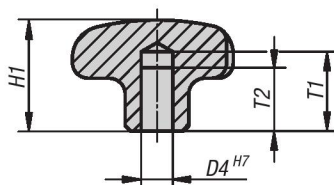

Style D
tapped with counter bore

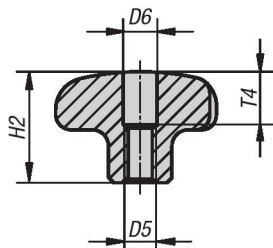

Style E
tapped blind hole

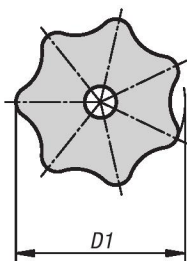
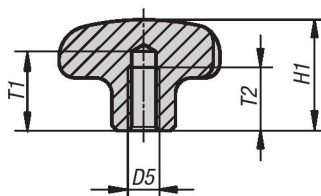

Material:
Stainless steel 1.4308

Type:
Ground and polished

Part Number Example:
K0150.232CM2

KIPP Star Grips in stainless steel similar to DIN 6336, inch

| Item No. Style B | Item No. Style C | Version | D1 | D2 | D4 | H1 | H2 | H3 | T1 | T2 |
|---------------------|---------------------|----------|----|----|------|------|------|----|------|------|
| K0150.232CM2 | K0150.332CM2 | polished | 32 | 12 | .250 | -.21 | 20/- | 10 | -.15 | -.12 |
| K0150.240CN2 | K0150.340CN2 | polished | 40 | 14 | .312 | -.26 | 25/- | 13 | -.18 | -.15 |
| K0150.250C02 | K0150.350C02 | polished | 50 | 18 | .375 | -.34 | 32/- | 17 | -.21 | -.18 |
| K0150.263CP2 | K0150.363CP2 | polished | 63 | 20 | .500 | -.42 | 40/- | 21 | -.25 | -.22 |

KIPP Star Grips in stainless steel similar to DIN 6336, inch

| Item No. Style D | Item No. Style E | Version | D1 | D2 | D5 | D6 | H1 | H2 | H3 | T1 | T2 | T4 |
|---------------------|---------------------|----------|----|----|---------|--------|------|------|----|------|------|------|
| K0150.432A22 | K0150.532A22 | polished | 32 | 12 | 1/4-20 | 6.4/- | -.21 | 20/- | 10 | -.15 | -.12 | 10/- |
| K0150.440A32 | K0150.540A32 | polished | 40 | 14 | 5/16-18 | 8.4/- | -.26 | 25/- | 13 | -.18 | -.15 | 12/- |
| K0150.450A42 | K0150.550A42 | polished | 50 | 18 | 3/8-16 | 10.5/- | -.34 | 32/- | 17 | -.21 | -.18 | 16/- |
| K0150.463A52 | K0150.563A52 | polished | 63 | 20 | 1/2-13 | 13/- | -.42 | 40/- | 21 | -.25 | -.22 | 20/- |

Star Grips

in stainless steel similar to DIN 6336



KIPP Star Grips in stainless steel similar to DIN 6336, metric

| Item No. Style B | Item No. Style C | Version | D1 | D2 | D4 | H1 | H2 | H3 | T1 | T2 |
|---------------------|---------------------|----------|----|----|----|------|------|----|------|------|
| K0150.232062 | K0150.332062 | polished | 32 | 12 | 6 | -/21 | 20/- | 10 | -/15 | -/12 |
| K0150.240082 | K0150.340082 | polished | 40 | 14 | 8 | -/26 | 25/- | 13 | -/18 | -/15 |
| K0150.250102 | K0150.350102 | polished | 50 | 18 | 10 | -/34 | 32/- | 17 | -/21 | -/18 |
| K0150.263122 | K0150.363122 | polished | 63 | 20 | 12 | -/42 | 40/- | 21 | -/25 | -/22 |

KIPP Star Grips in stainless steel similar to DIN 6336, metric

| Item No. Style D | Item No. Style E | Version | D1 | D2 | D5 | D6 | H1 | H2 | H3 | T1 | T2 | T4 |
|---------------------|---------------------|----------|----|----|-----|--------|------|------|----|------|------|------|
| K0150.432062 | K0150.532062 | polished | 32 | 12 | M6 | 6,4/- | -/21 | 20/- | 10 | -/15 | -/12 | 10/- |
| K0150.440082 | K0150.540082 | polished | 40 | 14 | M8 | 8,4/- | -/26 | 25/- | 13 | -/18 | -/15 | 12/- |
| K0150.450102 | K0150.550102 | polished | 50 | 18 | M10 | 10,5/- | -/34 | 32/- | 17 | -/21 | -/18 | 16/- |
| K0150.463122 | K0150.563122 | polished | 63 | 20 | M12 | 13/- | -/42 | 40/- | 21 | -/25 | -/22 | 20/- |