

Thrust Screws stainless steel

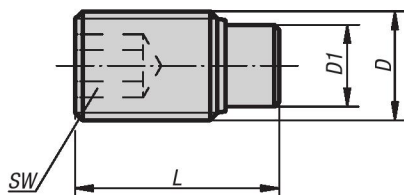

New Item

**Material:**

Screw stainless steel.
Bolts brass or POM.

Type:

Screw natural finish.

Part Number Example:

K0667.041X105 (include length L)

Note:

Thrust Screws are ideal for clamping or exerting pressure on threaded spindles, axles, shafts and treated surfaces without marring. Longer versions are specially designed to be glued in. They allow small to medium series of mechanical external thread fastening elements to be made cost-effectively.

KIPP Thrust Screws, stainless steel, metric

Item No.	Version	D	D1	L	SW
K0667.041X	bolt brass	M4	2,5	6,5/10,5/16,5/30,5/40,5	2
K0667.051X	bolt brass	M5	3	8,5/12,5/20,5/30,5/40,5	2,5
K0667.061X	bolt brass	M6	4	11,5/13,5/17,5/21,5/26,5/41,5/51,5/61,5	3
K0667.081X	bolt brass	M8	5,5	12/22/32/52/62/82	4
K0667.101X	bolt brass	M10	7	14/18/27/37	5
K0667.121X	bolt brass	M12	8,5	22,5/32,5/42,5	6

Item No.	Version	D	D1	L	SW
K0667.1041X	bolt POM	M4	2	7/9/11/13/17/31/41	2
K0667.1051X	bolt POM	M5	3	9/11/13/17/21/31/41	2,5
K0667.1061X	bolt POM	M6	3,5	11,3/13,3/17,3/21,3/26,3/41,3/51,3/61,3	3
K0667.1081X	bolt POM	M8	5	13,6/17,6/21,6/26,6/33,6/51,6/61,6/81,6	4
K0667.1101X	bolt POM	M10	6,5	17,9/21,9/26,9/36,9	5
K0667.1121X	bolt POM	M12	8	22,1/32,1/42,1	6