



Adjustable Latches

with a movable hook clamp

METRIC
Parts

latch
Style A

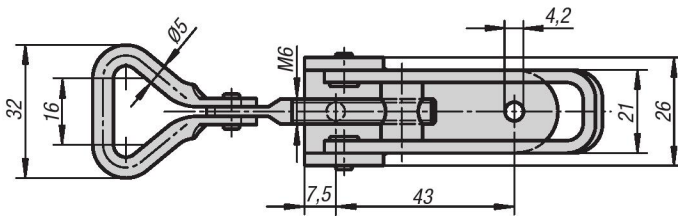
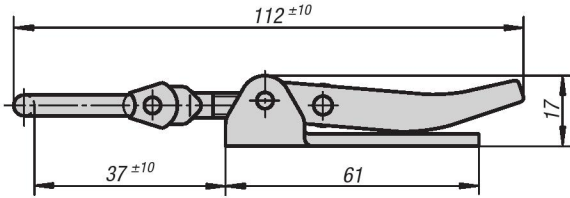

catch plate
Style A

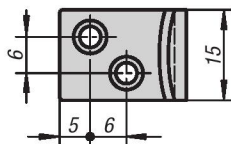
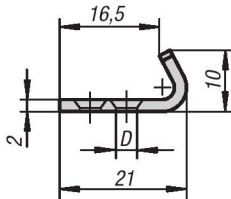

Material:

Steel or stainless steel 1.4301

Type:

Galvanized and blue chromate.
stainless steel natural finish.

Part Number Example:

Latch K0050.1421121
Catch plate K0050.9135211

Note:

Adjustable latches are safe locking systems for industrial applications. By exceeding the dead center they resist vibration. To compensate for tolerances the latch has a swing mounted bail.

After the bail is engaged with the catch plate, by pushing the lever down the parts to be locked can be drawn together by up to 15 mm. To compensate for tolerances or to create enough tension the bail length can be adjusted by the M6 threaded spindle.

The latches can be screwed down or riveted.

Order catch plates separately.

The retaining force F1 applies to the latch, not the catch plate.

On request:

Available with safeguard against unintentional opening.

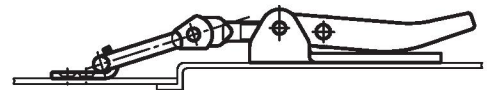

KIPP Adjustable Latches with a movable hook clamp, metric

Item No. steel	Item No. stainless steel	Style	Retaining force F1 N
K0050.1421121	K0050.1421122	A	1000

KIPP Catch plate, metric

Item No. steel	Item No. stainless steel	Style	D
K0050.9135211	K0050.9135212	A	3,7