

Indexing Plungers

without collar

INCH
Parts

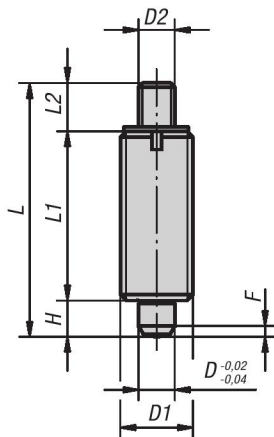

Style J
with threaded pin
without locknut

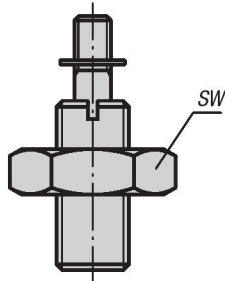

Style K
with threaded pin
with locknut

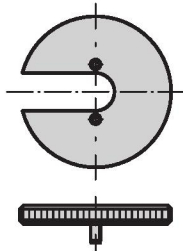

screw-in washer

Material:

- Steel version, locking pin hardened: quality class 5.8
- Stainless steel version, locking pin hardened: threaded sleeve 1.4305 locking pin 1.4034
- Stainless steel version, locking pin not hardened: threaded sleeve 1.4305 locking pin 1.4305

Type:

- Steel version, locking pin hardened: black oxide finish, locking pin ground
- Stainless steel version, locking pin hardened: natural finish, locking pin ground
- Stainless steel version, locking pin not hardened: natural finish, locking pin ground

Part Number Example:

K0345.1903AJ

Note:

Indexing Plungers are used to prevent any change in locking position due to lateral forces. A new locking position can only be set after the bolt has been disengaged.

Special grips can be fitted on the projecting threaded pin. This pin is also suitable for automatic actuation by e.g. program controlled pneumatic cylinder or by remote control using bowden cables.

A washer is available to aid screwing in the indexing plungers. The washer is placed on the threaded sleeve so that the carrier pins engage in the slot.

On request:

Special versions.



Indexing Plungers

without collar

KIPP Indexing Plungers, without collar, threaded pin, steel, locking pin hardened, inch

Item No. Style J	Item No. Style K	D	D1	D2	L	L1	L2	H	SW	F x 30°	Spring force initial pressure F1 approx. N	Spring force final pressure F2 approx. N	Item No. screw-in washer
K0345.1903AJ	K0345.2903AJ	3	1/4-28	M2	24	17	3.5	3.5	-17/16	.8	4.5	10	K0344.99
K0345.1004AK	K0345.2004AK	4	5/16-24	M3	32	21	7	4	-11/2	1	6	12	K0344.90
K0345.1105AL	K0345.2105AL	5	3/8-24	M4	37	24	8	5	-19/16	1.3	5	12	K0344.91
K0345.1206A5	K0345.2206A5	6	1/2-13	M6	42	28	8	6	-13/4	1.8	6	14	K0344.92
K0345.1308A6	K0345.2308A6	8	5/8-11	M8	56	36	12	8	-115/16	2.3	15	35	K0344.93
K0345.1410A7	K0345.2410A7	10	3/4-10	M8	62	40	12	10	-111/8	2.8	15	34	K0344.94
K0345.1412A0	K0345.2412A0	12	3/4-16	M8	66	42	12	12	-111/8	2.8	15	39	K0344.94
K0345.1516A8	K0345.2516A8	16	1"-8	M10	80	50	14	16	-111/2	3.2	20	46	K0344.95

KIPP Indexing Plungers, without collar, threaded pin, stainless steel, locking pin hardened, inch

Item No. Style J	Item No. Style K	D	D1	D2	L	L1	L2	H	SW	F x 30°	Spring force initial pressure F1 approx. N	Spring force final pressure F2 approx. N	Item No. screw-in washer
K0345.01903AJ	K0345.02903AJ	3	1/4-28	M2	24	17	3.5	3.5	-17/16	.8	4.5	10	K0344.99
K0345.01004AK	K0345.02004AK	4	5/16-24	M3	32	21	7	4	-11/2	1	6	12	K0344.90
K0345.01105AL	K0345.02105AL	5	3/8-24	M4	37	24	8	5	-19/16	1.3	5	12	K0344.91
K0345.01206A5	K0345.02206A5	6	1/2-13	M6	42	28	8	6	-13/4	1.8	6	14	K0344.92
K0345.01308A6	K0345.02308A6	8	5/8-11	M8	56	36	12	8	-115/16	2.3	15	35	K0344.93
K0345.01410A7	K0345.02410A7	10	3/4-10	M8	62	40	12	10	-111/8	2.8	15	34	K0344.94
K0345.01412A0	K0345.02412A0	12	3/4-16	M8	66	42	12	12	-111/8	2.8	15	39	K0344.94
K0345.01516A8	K0345.02516A8	16	1"-8	M10	80	50	14	16	-111/2	3.2	20	46	K0344.95

KIPP Indexing Plungers, without collar, threaded pin, stainless steel, locking pin not hardened, inch

Item No. Style J	Item No. Style K	D	D1	D2	L	L1	L2	H	SW	F x 30°	Spring force initial pressure F1 approx. N	Spring force final pressure F2 approx. N	Item No. screw-in washer
K0345.11903AJ	K0345.12903AJ	3	1/4-28	M2	24	17	3.5	3.5	-17/16	.8	4.5	10	K0344.99
K0345.11004AK	K0345.12004AK	4	5/16-24	M3	32	21	7	4	-11/2	1	6	12	K0344.90
K0345.11105AL	K0345.12105AL	5	3/8-24	M4	37	24	8	5	-19/16	1.3	5	12	K0344.91
K0345.11206A5	K0345.12206A5	6	1/2-13	M6	42	28	8	6	-13/4	1.8	6	14	K0344.92
K0345.11308A6	K0345.12308A6	8	5/8-11	M8	56	36	12	8	-115/16	2.3	15	35	K0344.93
K0345.11410A7	K0345.12410A7	10	3/4-10	M8	62	40	12	10	-111/8	2.8	15	34	K0344.94
K0345.11412A0	K0345.12412A0	12	3/4-16	M8	66	42	12	12	-111/8	2.8	15	39	K0344.94
K0345.11516A8	K0345.12516A8	16	1"-8	M10	80	50	14	16	-111/2	3.2	20	46	K0344.95