

# DESIGNING INNOVATION

## Expanding our Family of Round Traction Cups

The **20TC/50HT** Round Traction Vacuum Cup is a compact, high shear strength vacuum cup that is "surface-adaptable" for transfer press, crossbar and other material handling applications

### **20TC/50HT** Features

- For small areas that require high strength
- Automatically adapts to angled and contoured surfaces
- Durable rubber for long life

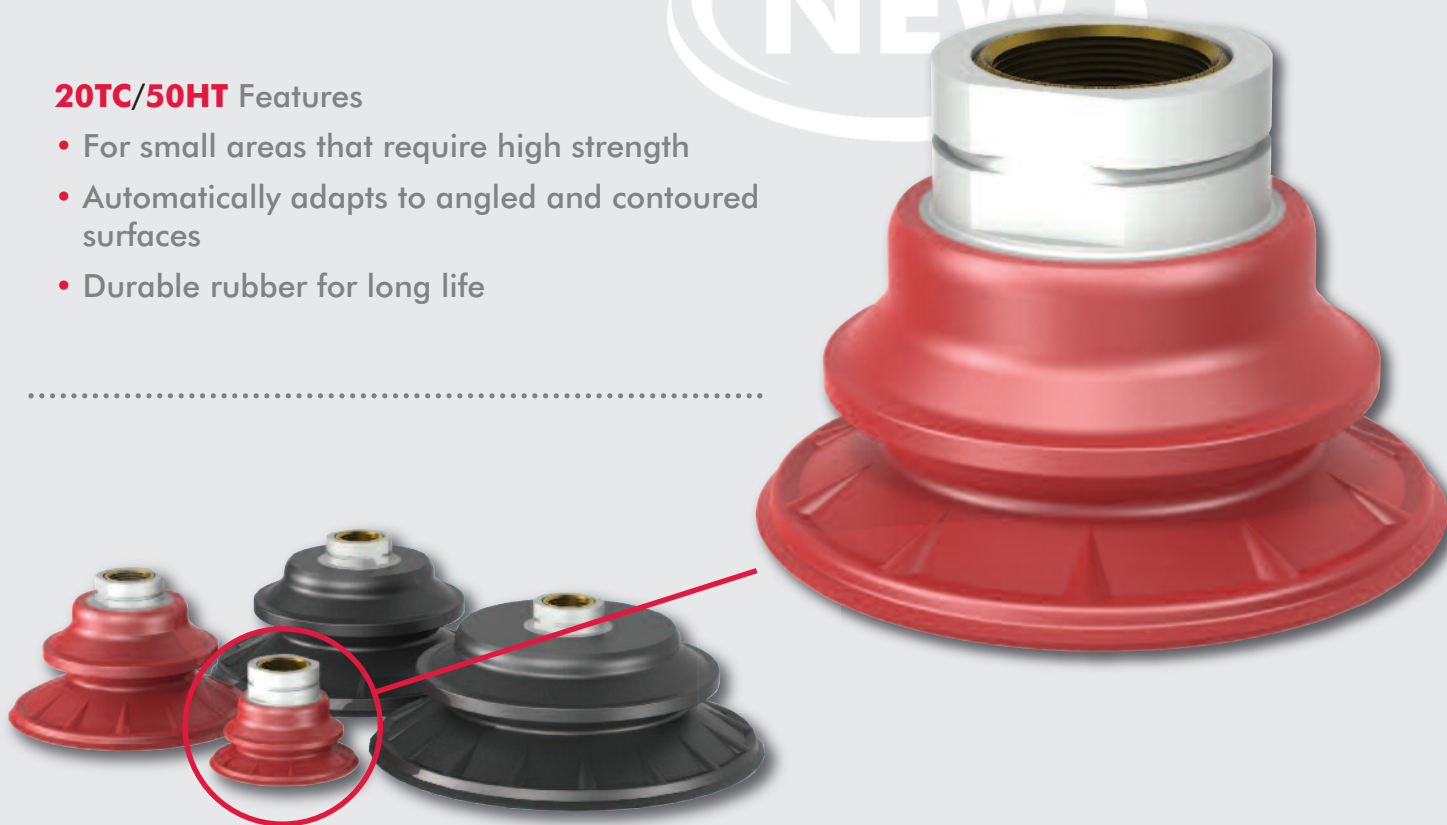

### Round Traction Vacuum Cup Family Features

- For applications with slick/oily surfaces or for destackers
- Internal cleats holds part more securely in high speed applications
- Bellows add flexibility for minor misalignments

For more information, please contact us: [solutions@destaco.com](mailto:solutions@destaco.com)



[www.destaco.com](http://www.destaco.com)

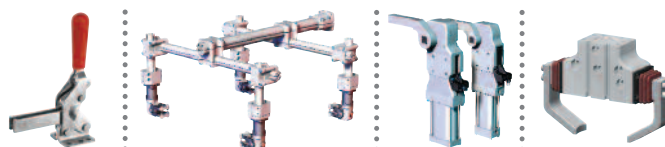

## TC/HT Round Traction Vacuum Cups



### Specifications:

Temperature:

15-59 Sec: -29° to 121° C [-20° to 250° F]

1-5 min: -9° to 82° C [15° to 180° F]

Material: Nitrile

Chemical Resistance: Oil, water, grease, hydraulic fluid, alcohol

### ACU INDEX

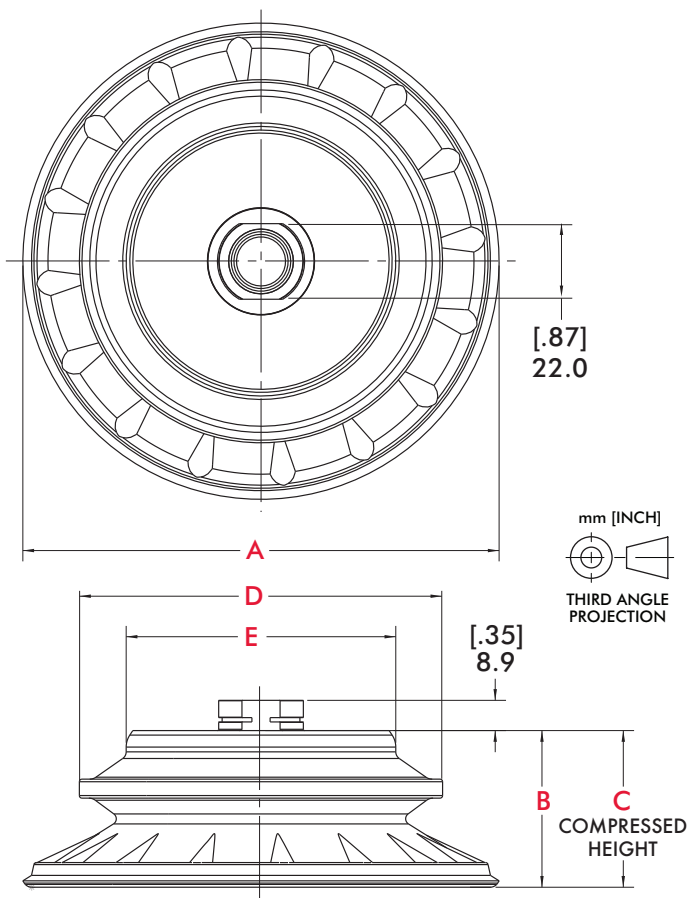

### TC/HT Holding Capacity

Application	Hor. Dry	Hor. Wet	Ver. Lift
[20TC]	[8.5 lb]	[7 lb]	3.2 [22.7 lb]
50HT	3.9 kg	kg	10.3 kg
[35TC]	[30 lb]	[20 lb]	[66 lb]
90HT	13.6 kg	9.1 kg	29.9 kg
[45TC]	[45 lb]	[30 lb]	[103 lb]
115HT	20.4 kg	13.6 kg	46.7 kg
[55TC]	[100 lb]	[45 lb]	[164 lb]
140HT	45.5 kg	20.4 kg	74.4 kg

### TC/HT Dimensions

Model	A	B	C	D	E	Weight
[20TC]	[2.06]	[1.02]	[.68]	[1.64]	[1.25]	[1.3 oz]
50HT	52.3	25.7	17.3	41.7	31.8	37 g
[35TC]	[3.50]	[1.71]	[.82]	[2.50]	[1.65]	[2.6 oz]
90HT	88.9	43.44	20.8	63.5	41.9	73 g
[45TC]	[4.50]	[1.81]	[.87]	[3.25]	[2.25]	[4.4 oz]
115HT	114.3	46.1	22.1	82.4	57.2	125 g
[55TC]	[5.50]	[1.81]	[.87]	[4.00]	[3.04]	[7.2 oz]
140HT	139.7	46.1	22.1	101.4	77.1	204 g

### TC/HT Round Traction Vacuum Cups Ordering Information

Imperial

Ø2.00" ..... CPI-20TC-(M)-(DR)  
 Ø3.50" ..... CPI-35TC-(M)-(DR)  
 Ø4.50" ..... CPI-45TC-(M)-(DR)  
 Ø5.50" ..... CPI-55TC-(M)-(DR)

(M) = Mounts Available

~~K~~ ~~B~~ ~~C~~ ~~D~~ ~~20TC~~ ~~E1~~ ~~20TC~~

(DR) = Durometer

~~45~~ ~~60~~

Metric

Ø50mm ..... CPI-50HT-(M)-(DR)  
 Ø90mm ..... CPI-90HT-(M)-(DR)  
 Ø115mm ..... CPI-115HT-(M)-(DR)  
 Ø140mm ..... CPI-140HT-(M)-(DR)

(M) = Mounts Available

~~A~~ ~~B~~ ~~C~~

(DR) = Durometer

~~45~~ ~~60~~